

Digital Fiber Sensors

E3X-DA-S







An Extensive of Standard Functions to Support the World's Highest Level of Stable Detection.

- "GIGA RAY" Giga Power Lighting Element to create a wide variety of value.
- Power turning to easily set the optimum light level.
- Active Threshold Control (ATC) reduces incorrect operation due to dust, oil, or other influences.
- Automatic Power Control (APC) is always enabled to stabilize emitter power with high accuracy.







Ordering Information

Amplifier Units [\[Dimensions→page 23\]](#)

Type	Appearance	Connecting method	Model		Applicable wire-saving connector (sold separately)	
			NPN output	PNP output	Type	Model
Standard models		Pre-wired (2 m)	E3X-DA21-S 2M	E3X-DA51-S 2M	---	---
		Wire-saving connector *	E3X-DA7-S	E3X-DA9-S	Master connector	E3X-CN21
					Slave connector	E3X-CN22
Ultra-long-term APC models		Pre-wired (2 m)	E3X-DA21R-S 2M	E3X-DA51R-S 2M	---	---
		Wire-saving connector *	E3X-DA7R-S	E3X-DA9R-S	Master connector	E3X-CN21
					Slave connector	E3X-CN22
High-speed response models		Pre-wired (2 m)	E3X-DA21F-S 2M	E3X-DA51F-S 2M	---	---
		Wire-saving connector *	E3X-DA7F-S	E3X-DA9F-S	Master connector	E3X-CN11
					Slave connector	E3X-CN12

* An Wire-saving connector sold separately is required.

Wire-saving connector (sold separately) Protection stickers attached [\[Dimensions→page 25\]](#)

Type	Appearance	Cable length	No. of conductors	Model
Master connector		2 m	4	E3X-CN21
Slave connector			2	E3X-CN22
Master connector			3	E3X-CN11
Slave connector			1	E3X-CN12

Note: The E3X-CN11/12 can also be used to connect to the E3X-DA□-S (□: 7/9) or the E3X-DA□R-S (□: 7/9), but the output lines will support only 1 channel. Output function for channel 2 or APC alarm output function will be disabled.

Accessories (sold separately)

Mounting Brackets [\[Dimensions→page 26\]](#)

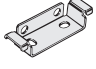
Appearance	Model	Quantity
	E39-L143	1

End Plate [\[Dimensions→page 26\]](#)

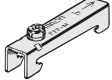
Appearance	Model	Quantity
	PFP-M	1

Product Overview

●: Strong point of the model ○: Provided ---: Not provided

Item		Types		Standard models		Ultra-long-term APC models		High-speed response models	
		Connecting method	Models	Pre-wired	Wire-saving connector	Pre-wired	Wire-saving connector	Pre-wired	Wire-saving connector
				E3X-DA21-S E3X-DA51-S	E3X-DA7-S E3X-DA9-S	E3X-DA21R-S E3X-DA51R-S	E3X-DA7R-S E3X-DA9R-S	E3X-DA21F-S E3X-DA51F-S	E3X-DA7F-S E3X-DA9F-S
Input/output	External input			1 input	---	1 input	---	---	
	Output			2 outputs		1 output and 1 APC alarm output		1 output	
Performance	Sensing distance with E32-T11R			280 to 2,000 mm (Depends on response time)		140 to 1,000 mm (Depends on response time)		280 mm (Only Super-high-speed Mode)	
	Sensing distance with E32-D11R			100 to 840 mm (Depends on response time)		50 to 420 mm (Depends on response time)		100 mm (Only Super-high-speed Mode)	
	Giga Power (GIGA RAY)			● (Margin: × 160)		○		○	
	High-speed response			○ (80 μs)		○ (80 μs)		● (46 μs)	
Function	Power tuning			○		○		○	
	Automatic power control (APC)			○		● (Ultra-long-term APC)		○	
	Timer			○		○		○	
	ATC			○		○		○	
	Key lock			○		○		○	
	Easy key lock (switchable)			---		○		○	
	APC margin display			---		○		---	
	Slow-motion display			---		---		○	

Ratings and Specifications

Amplifier Units

Type		Standard models	Ultra-long-term APC models	High-speed response models
Item	Model	E3X-DA□-S (□: 21/51/7/9)	E3X-DA□R-S (□: 21/51/7/9)	E3X-DA□F-S (□: 21/51/7/9)
Light source (wavelength)		Red,4-element LED (625 nm)		
Power supply voltage		12 to 24 VDC ±10%, ripple (p-p) 10% max.		
Power consumption		Normal mode : 960 mW max. (Current consumption: 40 mA max. at 24 VDC, 80 mA max. at 12 VDC) Power saving ECO1: 720 mW max. (Current consumption: 30 mA max. at 24 VDC, 60 mA max. at 12 VDC) Power saving ECO2: 600 mW max. (Current consumption: 25 mA max. at 24 VDC, 50 mA max. at 12 VDC)		
Control output / APC alarm output		Load power supply voltage: 26.4 VDC max.; NPN/PNP open collector; load current: 50 mA max.; residual voltage: 2 V max.		
External input *1		No-voltage input (contact / transistor) *2	---	
Protection circuits		Power supply reverse polarity protection, output short-circuit protection and output reverse polarity protection		
Re- sponse time	Super-high-speed Mode *3	Operate or reset: 80 μs		NPN output: Operate: 46 μs, Reset: 48 μs PNP output: Operate: 51 μs, Reset: 53 μs
	High-speed Mode	Operate or reset: 250 μs		---
	Standard Mode	Operate or reset: 1 ms		
	High-resolution Mode	Operate or reset: 4 ms		
	Tough Mode	Operate or reset: 16 ms		
Sensitivity setting		Teaching or manual method		
Func- tions	Power tuning	Light emission power and reception gain, digital control method		
	Differential detection	Switchable between Single-edge and Double-edge Detection Modes. Single edge: Set to 250 μs, 500 μs, 1 ms, 10 ms, or 100 ms. Double edge: Set to 500 μs, 1 ms, 2 ms, 20 ms, or 200 ms		---
	Automatic power control (APC)	Always enabled. High-speed control of emission current Wide-range APC for the E3X-DA□R-S		
	Timer	Select from timer disabled, OFF-delay, ON-delay, One-shot, or ON-delay + OFF-delay timer 1 ms to 5 s (1 to 20 ms set in 1-ms increments, 20 to 200 ms set in 10-ms increments, 200 ms to 1 s set in 100-ms increments, and 1 to 5 s set in 1-s increments)		
	ATC	Provided		
	APC margin display	---	Provided	---
	Slow-motion display	---		Provided
	Zero reset	Negative values can be displayed. (Threshold value is shifted.)		
	Resetting settings	Select from initial reset (factory defaults) or user reset (saved settings).		
	Mutual interference prevention	Possible for up to 10 units *4		---
	ECO Mode *5	Select from OFF (digital display lit), ECO1 (digital display dimmed), and ECO2 (digital display OFF).		
	External input setting *1	Select from teaching operations, power tuning, zero reset, emitter OFF, or ATC start.		---
	Output setting	Select from output for each channel, area output, or self-diagnosis.	---	
Indicator		Operation indicator for channel 1(orange) Operation indicator for channel 2(orange)	Operation indicator for channel 1(orange) APC alarm output indicator (orange)	Operation indicator for channel 1(orange) Power tuning indicator (orange)

*1. Only for Pre-wired models.

*2. The following details apply to inputs.

	Contact input (relay or switch)	Non-contact input (transistor)
NPN	ON: Shorted to 0 V (sourcing current: 1 mA max.). OFF: Open or shorted to Vcc.	ON: 1.5 V max. (sourcing current: 1 mA max.) OFF: Vcc - 1.5 V to Vcc (leakage current: 0.1 mA max.)
PNP	ON: Shorted to Vcc (sinking current: 3 mA max.). OFF: Open or shorted to 0 V.	ON: Vcc - 1.5 V to Vcc (sinking current: 3 mA max.) OFF: 1.5 V max. (leakage current: 0.1 mA max.)

*3. The communications function and mutual interference prevention function are disabled if detection is set to Super-high-speed mode.

*4. Mutual interference prevention is enabled if Amplifier Units are connected together. It is also enabled in the same way if E3X-DA-S-series Units and E3C-LDA-series Units are used together. If power tuning is enabled, mutual interference prevention can be used for up to six units.

*5. For the E3X-DA□-S (□: 21/51/7/9), the rated sensing distance is approximately 1/2 and the incident level is approximately 1/3 of the normal levels when ECO mode is enabled.

Item	Model	E3X-DA□-S (□: 21/51/7/9)	E3X-DA□R-S (□: 21/51/7/9)	E3X-DA□F-S (□: 21/51/7/9)
Digital display	Select from incident level + threshold or other 6 patterns (Refer to 6. <i>Display switch</i> on page 17.)			
Display orientation	Switching between normal / reversed display is possible.			
Key lock	Key lock		Key lock / Easy key lock.	
Ambient illumination (Receiver side)	Incandescent lamp: 10,000 lux max. Sunlight: 20,000 lux max.			
Maximum connectable Units	16 (The ambient temperature specification depends on the number of connected units.)			
Ambient temperature range	Operating: Groups of 1 to 2 Amplifiers: −25 to 55°C Groups of 3 to 10 Amplifiers: −25 to 50°C Groups of 11 to 16 Amplifiers: −25 to 45°C			
	Storage: −30 to 70°C (with no icing or condensation)			
Ambient humidity range	Operating and storage: 35% to 85% (with no condensation)			
Insulation resistance	20 MΩ min. (at 500 VDC)			
Dielectric strength	1,000 VAC at 50/60 Hz for 1 minute			
Vibration resistance	Destruction: 10 to 55 Hz with a 1.5-mm double amplitude for 2 hours each in X, Y and Z directions			
Shock resistance	Destruction: 500 m/s ² for 3 times each in X, Y and Z directions			
Degree of protection	IEC 60529 IP50 (with Protective Cover attached)			
Connection method	Pre-wired (standard length 2 m) or Wire-saving connector			
Weight (packed state)	Pre-wired models: Approx. 100 g, Wire-saving connector models: Approx. 55 g			
Materials	Case	Polybutylene terephthalate (PBT)		
	Cover	Polycarbonate (PC)		
Accessories	Instruction Manual			

Wire-saving connectors

Item	Model	E3X-CN21/22/11	E3X-CN12
Rated current		2.5 A	
Rated voltage		50 V	
Contact resistance		20 mΩ max. (20 mVDC max., 100 mA max.) (The figure is for connection to the Amplifier Unit and the adjacent connector. It does not include the conductor resistance of the cable.)	
No. of insertions		Destruction: 50 times (The figure for the number of insertions is for connection to the Amplifier Unit and the adjacent connector.)	
Materials	Housing	Polybutylene terephthalate (PBT)	
	Contacts	Phosphor bronze / gold-plated nickel	
Weight (packed state)		Approx. 55 g	Approx. 25 g

Sensing Distance

E3X-DA□-S (□: 21/51/7/9) ■ E3X-DA□F-S (□: 21/51/7/9)

Note: The E3X-DA□F-S uses only Super-high-speed mode. The sensing distance is the same as for the Super-high-speed mode of the E3X-DA□-S.

Fiber Unit				Amplifier Unit	E3X-DA□-S (□: 21/51/7/9)				
Screw-shaped model				Sensing distance (unit: mm)					
Sensing method	Size	Sensing direction	Model	Tough mode	High-resolution mode	Standard mode	High-speed mode	Super-high-speed mode	
Through-beam models	M3	Straight	E32-T21R 2M	450	300	250	150	60	
	M4	Right angle	E32-T11N 2M	2,000	1,400	1,000	700	280	
		Straight	E32-T11R 2M	2,000	1,400	1,000	700	280	
			E32-TC200 2M	2,800	2,000	1,550	1,000	400	
			E32-T11L 2M	4,000 *	3,400	2,700	1,740	700	
Reflective models	M3	Right angle	E32-C31N 2M	110	80	50	46	14	
		Straight	E32-D21R 2M	140	100	60	40	16	
			E32-C31 2M	330	240	150	100	44	
	M4	Straight	E32-D211R 2M	140	100	60	40	16	
	M6		Right angle	E32-D11N 2M	840	600	350	240	100
		Straight	E32-C11N 2M	780	560	350	320	100	
			E32-D11R 2M	840	600	350	240	100	
			E32-DC200 2M	1,400	1,000	600	400	180	
			E32-CC200 2M	1,400	1,000	600	400	180	
	E32-D11L 2M	1,820	1,300	800	520	220			

* The fiber length is 2 m on each side, so the sensing distance is given as 4,000 mm.

Fiber Unit				Amplifier Unit	E3X-DA□-S (□: 21/51/7/9)				
Flat model					Sensing distance (unit: mm)				
Sensing method	Sensing direction	Size	Model		Tough mode	High-resolution mode	Standard mode	High-speed mode	Super-high-speed mode
Through-beam models	Top view	Standard	E32-T15XR 2M		2,000	1,400	1,000	700	280
		Small	E32-T25XR 2M		450	300	250	150	60
	Side view	Standard	E32-T15YR 2M		750	550	450	260	100
		Small	E32-T25YR 2M		170	120	100	50	20
	Flat view	Standard	E32-T15ZR 2M		750	550	450	260	100
		Small	E32-T25ZR 2M		170	120	100	50	20
Reflective models	Top view	Standard	E32-D15XR 2M		840	600	350	240	100
		Small	E32-D25XR 2M		140	100	60	40	16
	Side view	Standard	E32-D15YR 2M		200	140	100	52	24
		Small	E32-D25YR 2M		40	28	16	10	4
	Flat view	Standard	E32-D15ZR 2M		200	140	100	52	24
		Small	E32-D25ZR 2M		40	28	16	10	4

Fiber Unit				Amplifier Unit	E3X-DA□-S (□: 21/51/7/9)				
Cylindrical model					Sensing distance (unit: mm)				
Sensing method	Sensing direction	Size	Model		Tough mode	High-resolution mode	Standard mode	High-speed mode	Super-high-speed mode
Through-beam models	Top view	φ1	E32-T223R 2M		450	300	250	150	60
		φ3	E32-T12R 2M		2,000	1,400	1,000	700	280
	Side view	φ1	E32-T24R 2M		170	120	100	50	20
		φ3	E32-T14LR 2M		750	550	450	260	100
Reflective models	Top view	φ1.5	E32-D22B 2M		140	100	60	40	16
		φ2	E32-D32 2M		330	240	150	100	44
		φ3	E32-D22R 2M		140	100	60	40	16
			E32-D32L 2M		700	500	300	200	90
	Side view	φ2	E32-D24R 2M		70	52	30	20	8
		φ6	E32-D14LR 2M		220	160	100	60	28

Fiber Unit				Amplifier Unit	E3X-DA□-S (□: 21/51/7/9)				
Model equipped with sleeve					Sensing distance (unit: mm)				
Sensing method	Sleeve size	Mounting size	Model		Tough mode	High-resolution mode	Standard mode	High-speed mode	Super-high-speed mode
Through-beam models	φ0.25 × 5	φ3	E32-T333-S5 1M		35	25	20	12	8
	φ0.5 × 40		E32-T33 1M		150	110	90	50	20
	φ0.9 × 40	M3	E32-TC200F4R 2M		450	300	250	150	60
	φ1.2 × 90	M4	E32-TC200BR 2M		2,000	1,400	1,000	700	280
Reflective models	φ0.5 × 15	φ2	E32-D331 2M		14	10	6	4	2
	φ0.8 × 15	φ3	E32-D33 2M		70	50	30	20	8
	φ1.2 × 40	M3	E32-DC200F4R 2M		140	100	60	40	16
	φ2.5 × 90	M6	E32-DC200BR 2M		840	600	350	240	100

For information on Fiber Units, refer to the Fiber Sensors Best Selection Catalog (Cat. No. E353).

E3X-DA□-S (□: 21/51/7/9) ■ E3X-DA□F-S(□: 21/51/7/9)

Note: The E3X-DA□F-S uses only Super-high-speed mode. The sensing distance is the same as for the Super-high-speed mode of the E3X-DA□-S.

Fiber Unit				Amplifier Unit		E3X-DA□-S (□: 21/51/7/9)				
Movable section (Flexibility)				Sensing distance (unit: mm)						
Sensing method	Type	Size	Model	Tough mode	High-resolution mode	Standard mode	High-speed mode	Super-high-speed mode		
Through-beam models	Screw-shaped model	M3	E32-T21 2M	680	480	400	220	90		
		M4	E32-T11 2M	2,500	1,800	1,350	900	360		
	Cylindrical model	φ1.5	E32-T22B 2M	680	480	400	220	90		
		φ3	E32-T12B 2M	2,500	1,800	1,350	900	360		
	Flat model	Standard	E32-T15XB 2M	2,500	1,800	1,350	900	360		
		Small	E32-T25XB 2M	500	360	300	170	70		
Reflective models	Screw-shaped model	M3	E32-D21 2M	140	100	60	40	16		
		M4	E32-D21B 2M	300	220	140	90	40		
		M6	E32-D11 2M	840	600	350	240	100		
	Cylindrical model	φ1.5	E32-D22B 2M	140	100	60	40	16		
		φ3	E32-D221B 2M	300	220	140	90	40		
	Flat model	Standard	E32-D15XB 2M	840	600	350	240	100		
		Small	E32-D25XB 2M	240	170	100	60	30		

Fiber Unit				Amplifier Unit		E3X-DA□-S (□: 21/51/7/9)				
Heat-resistance model				Sensing distance (unit: mm)						
Sensing method	Operating temperature	Lens	Model	Tough mode	High-resolution mode	Standard mode	High-speed mode	Super-high-speed mode		
Through-beam models	100°C	---	E32-T51R 2M	1,600	1,100	800	560	225		
		Lens	E32-T51R 2M + E39-F1	4,000 *	4,000 *	4,000 *	3,900	1,500		
		High-power lens	E32-T51R 2M + E39-F16	4,000 *	4,000 *	4,000 *	4,000 *	4,000 *		
	150°C	---	E32-T51 2M	2,800	2,000	1,500	1,000	400		
		Lens	E32-T51 2M + E39-F1-33	4,000 *	4,000 *	4,000 *	2,300	1,400		
		High-power lens	E32-T51 2M + E39-F16	4,000 *	4,000 *	4,000 *	4,000 *	4,000 *		
	200°C	---	E32-T54 2M	840	600	450	300	120		
			E32-T81R-S 2M	1,000	720	550	360	140		
		Lens	E32-T61-S 2M	1,680	1,200	900	600	240		
			E32-T61-S 2M + E39-F1	4,000 *	4,000 *	4,000 *	4,000 *	1,800		
	350°C	---	E32-T61-S 2M	1,680	1,200	900	600	240		
		High-power lens	E32-T61-S 2M + E39-F16	4,000 *	4,000 *	4,000 *	4,000 *	3,100		
Reflective models	100°C	---	E32-D51R 2M	670	480	280	190	80		
	150°C		E32-D51 2M	1,120	800	450	320	144		
	200°C		E32-D81R 2M	420	300	180	120	54		
	350°C		E32-D61 2M	420	300	180	120	54		
	400°C		E32-D73 2M	280	200	120	80	36		

* The fiber length is 2 m on each side, so the sensing distance is given as 4,000 mm.

Fiber Unit			Amplifier Unit		E3X-DA□-S (□: 21/51/7/9)				
Chemical-resistance / Oil-resistance model			Sensing distance (unit: mm)						
Sensing method	Type	Model	Tough mode	High-resolution mode	Standard mode	High-speed mode	Super-high-speed mode		
Through-beam models	φ5	E32-T12F 2M	4,000 *1	4,000 *1	4,000 *1	4,000 *1	1,600		
	φ7.2	E32-T11F 2M	4,000 *1	4,000 *1	4,000 *1	2,600	1,000		
	φ5 Heat-resistance model	E32-T51F 2M	4,000 *1	3,600	2,800	1,800	700		
	φ5 Side view	E32-T14F 2M	1,400	1,000	800	500	200		
	M4 Chemical-resistance cable	E32-T11U 2M	2,500	1,800	1,350	900	360		
	M4 Right angle Chemical-resistance cable	E32-T11NU 2M	1,440	1,040	800	520	200		
Reflective models	φ6	E32-D12F 2M	--- *2	320	190	130	60		
	φ7 Side view	E32-D14F 2M	--- *2	140	80	60	20		
	M6 Chemical-resistance cable	E32-D11U 2M	840	600	350	240	100		

*1. The fiber length is 2 m on each side, so the sensing distance is given as 4,000 mm.

*2. Even if there is no sensing object, the sensor will detect light that is reflected by the fluororesin.

Fiber Unit			Amplifier Unit	E3X-DA□-S (□: 21/51/7/9)				
Vacuum-resistance model				Sensing distance (unit: mm)				
Sensing method	Operating ambient temperature	Sensing direction	Model	Tough mode	High-resolution mode	Standard mode	High-speed mode	Super-high-speed mode
Through-beam models	120°C	Top view	E32-T51V 1M	720	520	400	260	100
			E32-T51V 1M + E39-F1V	3,780	2,700	2,000	1,360	520
	200°C	Right angle	E32-T54V 1M	580	420	250	200	70
			E32-T84SV 1M	1,760	1,250	950	640	260

For information on Fiber Units, refer to the Fiber Sensors Best Selection Catalog (Cat. No. E353).

E3X-DA□-S (□: 21/51/7/9) ■ E3X-DA□F-S(□: 21/51/7/9)

Note: The E3X-DA□F-S uses only Super-high-speed mode. The sensing distance is the same as for the Super-high-speed mode of the E3X-DA□-S.

Fiber Unit				Amplifier Unit	E3X-DA□-S (□: 21/51/7/9)				
Long distance / Dust resistance (High-power), Detection through gaps (Narrow vision field)					Sensing distance (unit: mm)				
Sensing method	Type	Sensing direction / Lens type	Model		Tough mode	High-resolution mode	Standard mode	High-speed mode	Super-high-speed mode
Through-beam models	High-power (integrated unit)	Top view	E32-T17L 10M		20,000 *1	20,000 *1	20,000 *1	20,000 *1	8,000
		Side view	E32-T14 2M		4,000 *2	4,000 *2	4,000 *2	4,000 *2	1,800
	High-power (with lens unit)	High-power	E32-T11N 2M + E39-F1		4,000 *2	4,000 *2	4,000 *2	4,000 *2	2,000
		Ultrahigh-power	E32-T11N 2M + E39-F16		4,000 *2	4,000 *2	4,000 *2	4,000 *2	3,600
		High-power	E32-T11R 2M + E39-F1		4,000 *2	4,000 *2	4,000 *2	4,000 *2	2,000
		Ultrahigh-power	E32-T11R 2M + E39-F16		4,000 *2	4,000 *2	4,000 *2	4,000 *2	3,600
		Side view	E32-T11R 2M + E39-F2		1,450	1,040	800	500	200
		High-power	E32-TC200 2M + E39-F1		4,000 *2	4,000 *2	4,000 *2	4,000 *2	3,000
		Ultrahigh-power	E32-TC200 2M + E39-F16		4,000 *2	4,000 *2	4,000 *2	4,000 *2	4,000 *2
		Side view	E32-TC200 2M + E39-F2		2,350	1,680	1,400	900	320
		High-power	E32-T11 2M + E39-F1		4,000 *2	4,000 *2	4,000 *2	4,000 *2	1,860
		Ultrahigh-power	E32-T11 2M + E39-F16		4,000 *2	4,000 *2	4,000 *2	4,000 *2	4,000 *2
		Side view	E32-T11 2M + E39-F2		2,300	1,640	1,320	860	320
		High-power	E32-T11U 2M + E39-F1		4,000 *2	4,000 *2	4,000 *2	4,000 *2	1,860
		Ultrahigh-power	E32-T11U 2M + E39-F16		4,000 *2	4,000 *2	4,000 *2	4,000 *2	4,000 *2
		Side view	E32-T11U 2M + E39-F2		2,300	1,640	1,320	860	320
		High-power	E32-T11NU 2M + E39-F1		4,000 *2	4,000 *2	4,000 *2	2,600	1,000
		Ultrahigh-power	E32-T11NU 2M + E39-F16		4,000 *2	4,000 *2	4,000 *2	4,000 *2	2,800
		High-power	E32-T81R-S 2M + E39-F1		4,000 *2	4,000 *2	4,000 *2	2,700	1,000
		Ultrahigh-power	E32-T81R-S 2M + E39-F16		4,000 *2	4,000 *2	4,000 *2	4,000 *2	1,800
		Side view	E32-T81R-S 2M + E39-F2		1,000	720	550	360	140
		High-power	E32-T61-S 2M + E39-F1		4,000 *2	4,000 *2	4,000 *2	4,000 *2	1,800
		Ultrahigh-power	E32-T61-S 2M + E39-F16		4,000 *2	4,000 *2	4,000 *2	4,000 *2	3,100
		Side view	E32-T61-S 2M + E39-F2		1,680	1,200	900	600	240
	Narrow vision field (aperture angle: 4°)	Top view	E32-T22S 2M		4,000 *2	4,000 *2	3,800	2,500	1,000
		Side view	E32-T24S 2M		4,000 *2	3,500	2,600	1,740	700
Reflective models	High-power	Top view	E32-D16 2M		40 to 2,800	40 to 2,000	40 to 1,400	40 to 900	40 to 480

*1. The fiber length is 10 m on each side, so the sensing distance is given as 20,000 mm.

*2. The fiber length is 2 m on each side, so the sensing distance is given as 4,000 mm.

Fiber Unit				Amplifier Unit	E3X-DA□-S (□: 21/51/7/9)				
Minute object detection (Small-spot model)					Sensing distance (unit: mm)				
Sensing method	Spot diameter (mm)	Focal length (mm)	Model		Tough mode	High-resolution mode	Standard mode	High-speed mode	Super-high-speed mode
Reflective models	φ0.1 to 0.6 (Variable)	6 to 15	E32-C42 1M + E39-F3A		Spot diameter of 0.1 to 0.6 mm at 6 to 15 mm				
	φ0.3 to 1.6 (Variable)	10 to 30	E32-C42 1M + E39-F17		Spot diameter of 0.3 to 1.6 mm at 10 to 30 mm				
	φ0.1	5	E32-C42S 1M		Spot diameter of 0.1 mm at 5 mm				
		7	E32-C41 1M + E39-F3A-5		Spot diameter of 0.1 mm at 7 mm				
	φ0.2	17	E32-C41 1M + E39-F3B		Spot diameter of 0.2 mm at 17 mm				
		7	E32-C31 2M + E39-F3A-5		Spot diameter of 0.5 mm at 7 mm				
	φ0.5	17	E32-C31 2M + E39-F3B		Spot diameter of 0.5 mm at 17 mm				
		50	E32-L15 2M		Spot diameter of 6 mm at 50 mm Sensing distance in all mode (40 to 100 mm)				
	φ4 Parallel light	0 to 20	E32-C31 2M + E39-F3C		Spot diameter of 4 mm max. at 0 to 20 mm				
	φ3	50	E32-C11N 2M + E39-F18		Spot diameter of 3 mm at 50 mm				
			E32-CC200 2M + E39-F18		Spot diameter of 3 mm at 50 mm				

Fiber Unit				Amplifier Unit	E3X-DA□-S (□: 21/51/7/9)				
Area-sensing (Area beam)					Sensing distance (unit: mm)				
Sensing method	Area range	Sensing direction	Model		Tough mode	High-resolution mode	Standard mode	High-speed mode	Super-high-speed mode
Through-beam models	11 mm	Side view	E32-T16PR 2M		3,100	2,200	1,700	1,120	440
		Flat view	E32-T16JR 2M		2,750	2,000	1,500	960	380
	30 mm	Side view	E32-T16WR 2M		4,000 *	3,400	2,600	1,700	680
Reflective models	11 mm		E32-D36P1 2M		700	500	300	200	90

* The fiber length is 2 m on each side, so the sensing distance is given as 4,000 mm.

For information on Fiber Units, refer to the Fiber Sensors Best Selection Catalog (Cat. No. E353).

E3X-DA-S

E3X-DA□-S (□: 21/51/7/9) ■ E3X-DA□F-S(□: 21/51/7/9)

Note: The E3X-DA□F-S uses only Super-high-speed mode. The sensing distance is the same as for the Super-high-speed mode of the E3X-DA□-S.

Fiber Unit				Amplifier Unit	E3X-DA□-S (□: 21/51/7/9)				
Detection without background interference (Convergent-reflective)				Sensing distance (unit: mm)					
Sensing method	Sensing direction	Size	Model	Tough mode	High-resolution mode	Standard mode	High-speed mode	Super-high-speed mode	
Reflective models	Flat view	Standard	E32-L16-N 2M *	0 to 15					0 to 12
		Small	E32-L24S 2M *	0 to 4					
	Top view	---	E32-L25L 2M *	5.4 to 9 (center 7.2)					
	Flat view		E32-L24L 2M *	2 to 6 (center 4)					

* If operation is affected by the background, perform power tuning or set operation to ECO mode to reduce the amount of light that is received.

Fiber Unit			Amplifier Unit	E3X-DA□-S (□: 21/51/7/9)				
Detection of transparent objects (Retro-reflective)				Sensing distance (unit: mm)				
Sensing method	Type	Model		Tough mode	High-resolution mode	Standard mode	High-speed mode	Super-high-speed mode
Retro-reflective models	Square	E32-R16 5M + E39-R1 (attached) *1		150 to 1,500				
	Small	E32-R21 2M + E39-R3 (attached) *1		10 to 250				
	Film detection *2	E32-C31 2M + E39-F3R+E39-RP37 *1		250			200	---
		E32-C31 2M + E39-F3R+E39-RSP1 *1		450			300	100

*1. When using a highly reflective object, light reflected from the object may affect the sensor.

*2. The effect may be small due to the film. Also, stable detection may not be possible when there is a sensing object directly in front of the Lens Unit. Be sure to check operation in advance.

Fiber Unit				Amplifier Unit	E3X-DA□-S (□: 21/51/7/9)				
FPD / Semiconductor / Solar battery industry				Sensing distance (unit: mm)					
Sensing method	Application	Operating temperature	Model	Tough mode	High-resolution mode	Standard mode	High-speed mode	Super-high-speed mode	
Reflective models	Glass detection	70°C	E32-L16-N 2M *	0 to 15				0 to 12	
	Glass substrate alignment		E32-L16-N 2M *	0 to 15				0 to 12	
			E32-A08 2M *	10 to 20				---	
	Glass substrate mapping	300°C	E32-A08H2 3M *	10 to 20				---	
		70°C	E32-A09 2M	15 to 38				---	
		150°C	E32-A09H 2M	15 to 38				---	
		300°C	E32-A09H2 2M	20 to 30				---	
	WET process	60°C	E32-L11FP 5M	8 to 20 mm from end of lens (recommended: 11 mm)					
		70°C	E32-L12FS 5M	8 to 20 mm from end of lens (recommended: 11 mm)					
		85°C	E32-L11FS 5M	8 to 20 mm from end of lens (recommended: 11 mm)					
Through-beam models	Wafer mapping	70°C	E32-A03 2M	3,220	2,300	1,780	1,200	500	
			E32-A03-1 2M	3,220	2,300	1,780	1,200	500	
			E32-A04 2M	1,280	920	680	450	200	
			E32-A04-1 2M	1,280	920	680	450	200	

* If operation is affected by the background, perform power tuning or set operation to ECO mode to reduce the amount of light that is received.

Fiber Unit				Amplifier Unit	E3X-DA□-S (□: 21/51/7/9)				
Liquid-level detection model				Sensing distance (unit: mm)					
Sensing method	Sensing direction	Pipe diameter	Model	Tough mode	High-resolution mode	Standard mode	High-speed mode	Super-high-speed mode	
Reflective models	Mounted to pipe	No limit	E32-D36T 5M *1, *2	Applicable pipe: Transparent (no restriction on diameter)					
		φ8 to 10 mm	E32-L25T 2M	Applicable pipe: Transparent pipe with diameter of 8 to 10 mm, recommended pipe wall thickness: 1 mm					
	Wet	---	E32-D82F1 4M *1	Wet model					

*1. If a high level of light is received, perform power tuning or set operation to ECO mode to reduce the amount of light that is received.

*2. In Tough mode, detection may not be possible depending on the pipe diameter. Check operation with the pipe that will be used.

For information on Fiber Units, refer to the Fiber Sensors Best Selection Catalog (Cat. No. E353).

E3X-DA□R-S (□: 21/51/7/9)

Fiber Unit				Amplifier Unit	E3X-DA□R-S (□: 21/51/7/9)				
Screw-shaped model				Sensing distance (unit: mm)					
Sensing method	Size	Sensing direction	Model	Tough mode	High-resolution mode	Standard mode	High-speed mode	Super-high-speed mode	
Through-beam models	M3	Straight	E32-T21R 2M	220	160	130	75	30	
	M4	Right angle	E32-T11N 2M	1,000	700	500	350	140	
		Straight	E32-T11R 2M	1,000	700	530	350	140	
			E32-TC200 2M	1,400	1,000	760	500	200	
			E32-T11L 2M	2,000	1,700	1,350	870	350	
Reflective models	M3	Right angle	E32-C31N 2M	55	40	25	23	7	
		Straight	E32-D21R 2M	70	50	30	20	8	
			E32-C31 2M	165	120	75	50	22	
	M4	Right angle	E32-D211R 2M	70	50	30	20	8	
	M6		E32-D11N 2M	420	300	175	120	50	
			E32-C11N 2M	390	280	175	160	50	
			E32-D11R 2M	420	300	170	120	50	
			E32-DC200 2M	700	500	300	200	90	
			E32-CC200 2M	700	500	300	200	90	
			E32-D11L 2M	910	650	400	260	110	

Fiber Unit				Amplifier Unit	E3X-DA□R-S (□: 21/51/7/9)				
Flat model					Sensing distance (unit: mm)				
Sensing method	Sensing direction	Size	Model		Tough mode	High-resolution mode	Standard mode	High-speed mode	Super-high-speed mode
Through-beam models	Top view	Standard	E32-T15XR 2M		1,000	700	530	350	140
		Small	E32-T25XR 2M		220	160	130	75	30
	Side view	Standard	E32-T15YR 2M		370	270	210	130	50
		Small	E32-T25YR 2M		85	60	50	25	10
	Flat view	Standard	E32-T15ZR 2M		370	270	210	130	50
		Small	E32-T25ZR 2M		85	60	50	25	10
Reflective models	Top view	Standard	E32-D15XR 2M		420	300	170	120	50
		Small	E32-D25XR 2M		70	50	30	20	8
	Side view	Standard	E32-D15YR 2M		100	70	40	26	12
		Small	E32-D25YR 2M		20	14	8	5	2
	Flat view	Standard	E32-D15ZR 2M		100	70	40	26	12
		Small	E32-D25ZR 2M		20	14	8	5	2

Fiber Unit				Amplifier Unit	E3X-DA□R-S (□: 21/51/7/9)				
Cylindrical model					Sensing distance (unit: mm)				
Sensing method	Sensing direction	Size	Model		Tough mode	High-resolution mode	Standard mode	High-speed mode	Super-high-speed mode
Through-beam models	Top view	φ1	E32-T223R 2M		220	160	130	75	30
		φ3	E32-T12R 2M		1,000	700	530	350	140
	Side view	φ1	E32-T24R 2M		85	60	50	25	10
		φ3	E32-T14LR 2M		370	270	210	130	50
Reflective models	Top view	φ1.5	E32-D22B 2M		70	50	30	20	8
		φ2	E32-D32 2M		160	120	75	50	22
			E32-D22R 2M		70	50	30	20	8
		φ3	E32-D32L 2M		350	250	150	100	45
	Side view	φ2	E32-D24R 2M		35	26	15	10	4
		φ6	E32-D14LR 2M		110	80	45	30	14

Fiber Unit				Amplifier Unit	E3X-DA□R-S (□: 21/51/7/9)				
Model equipped with sleeve					Sensing distance (unit: mm)				
Sensing method	Sleeve size	Mounting size	Model		Tough mode	High-resolution mode	Standard mode	High-speed mode	Super-high-speed mode
Through-beam models	φ0.25 × 5	φ3	E32-T333-S5 1M		17	12	10	6	4
	φ0.5 × 40		E32-T33 1M		75	55	45	25	10
	φ0.9 × 40	M3	E32-TC200F4R 2M		220	160	130	75	30
	φ1.2 × 90	M4	E32-TC200BR 2M		1,000	700	530	350	140
Reflective models	φ0.5 × 15	φ2	E32-D331 2M		7	5	3	2	0.8
	φ0.8 × 15	φ3	E32-D33 2M		35	25	16	10	4
	φ1.2 × 40	M3	E32-DC200F4R 2M		70	50	30	20	8
	φ2.5 × 90	M6	E32-DC200BR 2M		420	300	170	120	50

For information on Fiber Units, refer to the Fiber Sensors Best Selection Catalog (Cat. No. E353).

E3X-DA-S

E3X-DA□R-S (□: 21/51/7/9)

Fiber Unit				Amplifier Unit		E3X-DA□R-S (□: 21/51/7/9)				
Movable section (Flexibility)				Sensing distance (unit: mm)						
Sensing method	Type	Size	Model	Tough mode	High-resolution mode	Standard mode	High-speed mode	Super-high-speed mode		
Through-beam models	Screw-shaped model	M3	E32-T21 2M	340	240	200	110	45		
		M4	E32-T11 2M	1,250	900	680	450	180		
	Cylindrical model	φ1.5	E32-T22B 2M	340	240	200	110	45		
		φ3	E32-T12B 2M	1,250	900	680	450	180		
	Flat model	Standard	E32-T15XB 2M	1,250	900	680	450	180		
		Small	E32-T25XB 2M	250	180	150	85	35		
Reflective models	Screw-shaped model	M3	E32-D21 2M	70	50	30	20	8		
		M4	E32-D21B 2M	150	110	70	45	20		
		M6	E32-D11 2M	420	300	170	120	50		
	Cylindrical model	φ1.5	E32-D22B 2M	70	50	30	20	8		
		φ3	E32-D221B 2M	150	110	70	45	20		
	Flat model	Standard	E32-D15XB 2M	420	300	170	120	50		
		Small	E32-D25XB 2M	120	85	50	30	15		

Fiber Unit				Amplifier Unit		E3X-DA□R-S (□: 21/51/7/9)				
Heat-resistance model				Sensing distance (unit: mm)						
Sensing method	Operating temperature	Lens	Model	Tough mode	High-resolution mode	Standard mode	High-speed mode	Super-high-speed mode		
Through-beam models	100°C	---	E32-T51R 2M	800	560	425	280	110		
		Lens	E32-T51R 2M + E39-F1	4,000 *	3,900	2,900	1,900	760		
		High-power lens	E32-T51R 2M + E39-F16	4,000 *	4,000 *	4,000 *	3,600	1,400		
	150°C	---	E32-T51 2M	1,400	1,000	760	500	200		
		Lens	E32-T51 2M + E39-F1-33	4,000 *	3,400	2,660	1,150	700		
		High-power lens	E32-T51 2M + E39-F16	4,000 *	4,000 *	4,000 *	4,000 *	2,600		
	200°C	---	E32-T54 2M	420	300	230	150	60		
			E32-T81R-S 2M	500	360	280	180	70		
		E32-T61-S 2M	840	600	450	300	120			
		Lens	E32-T61-S 2M + E39-F1	4,000 *	4,000 *	3,400	2,200	900		
	350°C	---	E32-T61-S 2M	840	600	450	300	120		
		High-power lens	E32-T61-S 2M + E39-F16	4,000 *	4,000 *	4,000 *	3,900	1,500		
Reflective models	100°C	---	E32-D51R 2M	330	240	135	95	40		
	150°C		E32-D51 2M	560	400	230	160	72		
	200°C		E32-D81R 2M	210	150	90	60	27		
	350°C		E32-D61 2M	210	150	90	60	27		
	400°C		E32-D73 2M	140	100	60	40	18		

* The fiber length is 2 m on each side, so the sensing distance is given as 4,000 mm.

Fiber Unit			Amplifier Unit		E3X-DA□R-S (□: 21/51/7/9)				
Chemical-resistance / Oil-resistance model			Sensing distance (unit: mm)						
Sensing method	Type	Model	Tough mode	High-resolution mode	Standard mode	High-speed mode	Super-high-speed mode		
Through-beam models	φ5	E32-T12F 2M	4,000 *1	4,000 *1	3,000	2,000	800		
	φ7.2	E32-T11F 2M	3,500	2,500	2,000	1,300	520		
	Heat-resistance model	E32-T51F 2M	2,500	1,800	1,400	900	350		
	φ5 Side view	E32-T14F 2M	700	500	400	250	100		
	M4 Chemical-resistance cable	E32-T11U 2M	1,250	900	680	450	180		
	M4 Right angle Chemical-resistance cable	E32-T11NU 2M	720	520	400	260	100		
	Reflective models	φ6	E32-D12F 2M	--- *2	160	95	65	30	
φ7 Side view		E32-D14F 2M	--- *2	70	40	30	10		
M6 Chemical-resistance cable		E32-D11U 2M	420	300	170	120	50		

*1. The fiber length is 2 m on each side, so the sensing distance is given as 4,000 mm.

*2. The sensor will detect light even if there is no sensing object, and so Tough Mode cannot be used.

Fiber Unit				Amplifier Unit		E3X-DA□R-S (□: 21/51/7/9)				
Vacuum-resistance model				Sensing distance (unit: mm)						
Sensing method	Operating ambient temperature	Sensing direction	Model	Tough mode	High-resolution mode	Standard mode	High-speed mode	Super-high-speed mode		
Through-beam models	120°C	Top view	E32-T51V 1M	360	260	200	130	50		
			E32-T51V 1M + E39-F1V	1,890	1,350	1,000	680	260		
	200°C	Right angle	E32-T54V 1M	290	210	130	100	35		
			E32-T84SV 1M	880	630	480	320	130		

For information on Fiber Units, refer to the Fiber Sensors Best Selection Catalog (Cat. No. E353).

E3X-DA□R-S (□: 21/51/7/9)

Fiber Unit				Amplifier Unit	E3X-DA□R-S (□: 21/51/7/9)				
Long distance / Dust resistance (High-power), Detection through gaps (Narrow vision field)					Sensing distance (unit: mm)				
Sensing method	Type	Sensing direction / Lens type	Model		Tough mode	High-resolution mode	Standard mode	High-speed mode	Super-high-speed mode
Through-beam models	High-power (integrated unit)	Top view	E32-T17L 10M		20,000 *1	20,000 *1	20,000 *1	10,000	4,000
		Side view	E32-T14 2M		4,000 *2	4,000 *2	3,400	2,250	900
	High-power (with lens unit)	High-power	E32-T11N 2M + E39-F1		4,000 *2	4,000 *2	3,700	2,400	970
		Ultrahigh-power	E32-T11N 2M + E39-F16		4,000 *2	4,000 *2	4,000 *2	4,000 *2	1,800
		High-power	E32-T11R 2M + E39-F1		4,000 *2	4,000 *2	3,700	2,400	970
		Ultrahigh-power	E32-T11R 2M + E39-F16		4,000 *2	4,000 *2	4,000 *2	4,000 *2	1,800
		Side view	E32-T11R 2M + E39-F2		725	520	400	250	100
		High-power	E32-TC200 2M + E39-F1		4,000 *2	4,000 *2	4,000 *2	2,600	1,500
		Ultrahigh-power	E32-TC200 2M + E39-F16		4,000 *2	4,000 *2	4,000 *2	4,000 *2	4,000 *2
		Side view	E32-TC200 2M + E39-F2		1,170	840	700	450	160
		High-power	E32-T11 2M + E39-F1		4,000 *2	4,000 *2	3,600	2,300	930
		Ultrahigh-power	E32-T11 2M + E39-F16		4,000 *2	4,000 *2	4,000 *2	4,000 *2	2,300
		Side view	E32-T11 2M + E39-F2		1,150	820	660	430	160
		High-power	E32-T11U 2M + E39-F1		4,000 *2	4,000 *2	3,600	2,300	930
		Ultrahigh-power	E32-T11U 2M + E39-F16		4,000 *2	4,000 *2	4,000 *2	4,000 *2	2,300
		Side view	E32-T11U 2M + E39-F2		1,150	820	660	430	160
		High-power	E32-T11NU 2M + E39-F1		4,000 *2	2,600	2,000	1,300	500
		Ultrahigh-power	E32-T11NU 2M + E39-F16		4,000 *2	4,000 *2	4,000 *2	3,300	1,300
		High-power	E32-T81R-S 2M + E39-F1		4,000 *2	2,650	2,100	1,300	520
		Ultrahigh-power	E32-T81R-S 2M + E39-F16		4,000 *2	4,000 *2	3,600	2,300	900
		Side view	E32-T81R-S 2M + E39-F2		500	360	280	180	70
		High-power	E32-T61-S 2M + E39-F1		4,000 *2	4,000 *2	3,400	2,200	900
		Ultrahigh-power	E32-T61-S 2M + E39-F16		4,000 *2	4,000 *2	4,000 *2	3,900	1,500
		Side view	E32-T61-S 2M + E39-F2		840	600	450	300	120
	Narrow vision field (aperture angle: 4°)	Top view	E32-T22S 2M		3,500	2,500	1,900	1,250	500
		Side view	E32-T24S 2M		2,400	1,750	1,300	870	350
Reflective models	High-power	Top view	E32-D16 2M		40 to 1,400	40 to 1,000	40 to 700	40 to 450	40 to 240

*1. The fiber length is 10 m on each side, so the sensing distance is given as 20,000 mm.

*2. The fiber length is 2 m on each side, so the sensing distance is given as 4,000 mm.

Fiber Unit				Amplifier Unit	E3X-DA□R-S (□: 21/51/7/9)				
Minute object detection (Small-spot model)					Sensing distance (unit: mm)				
Sensing method	Spot diameter (mm)	Focal length (mm)	Model		Tough mode	High-resolution mode	Standard mode	High-speed mode	Super-high-speed mode
Reflective models	φ0.1 to 0.6 (Variable)	6 to 15	E32-C42 1M + E39-F3A		Spot diameter of 0.1 to 0.6 mm at 6 to 15 mm				
	φ0.3 to 1.6 (Variable)	10 to 30	E32-C42 1M + E39-F17		Spot diameter of 0.3 to 1.6 mm at 10 to 30 mm				
	φ0.1	5	E32-C42S 1M		Spot diameter of 0.1 mm at 5 mm				
		7	E32-C41 1M + E39-F3A-5		Spot diameter of 0.1 mm at 7 mm				
	φ0.2	17	E32-C41 1M + E39-F3B		Spot diameter of 0.2 mm at 17 mm				
	φ0.5	7	E32-C31 2M + E39-F3A-5		Spot diameter of 0.5 mm at 7 mm				
		17	E32-C31 2M + E39-F3B		Spot diameter of 0.5 mm at 17 mm				
	φ6	50	E32-L15 2M		Spot diameter of 6 mm at 50 mm Sensing distance in all mode (40 to 100 mm)				
	φ4 Parallel light	0 to 20	E32-C31 2M + E39-F3C		Spot diameter of 4 mm max. at 0 to 20 mm				
	φ3	50	E32-C11N 2M + E39-F18		Spot diameter of 3 mm at 50 mm				
			E32-CC200 2M + E39-F18		Spot diameter of 3 mm at 50 mm				

Fiber Unit				Amplifier Unit	E3X-DA□R-S (□: 21/51/7/9)				
Area-sensing (Area beam)					Sensing distance (unit: mm)				
Sensing method	Area range	Sensing direction	Model		Tough mode	High-resolution mode	Standard mode	High-speed mode	Super-high-speed mode
Through-beam models	11mm	Side view	E32-T16PR 2M		1,550	1,100	840	560	220
		Flat view	E32-T16JR 2M		1,370	980	750	480	190
	30mm	Side view	E32-T16WR 2M		2,000	1,700	1,300	850	340
Reflective models	11mm		E32-D36P1 2M		350	250	150	100	45

For information on Fiber Units, refer to the Fiber Sensors Best Selection Catalog (Cat. No. E353).

E3X-DA-S

E3X-DA□R-S (□: 21/51/7/9)

Fiber Unit				Amplifier Unit		E3X-DA□R-S (□: 21/51/7/9)				
Detection without background interference (Convergent-reflective)				Sensing distance (unit: mm)						
Sensing method	Sensing direction	Size	Model	Tough mode	High-resolution mode	Standard mode	High-speed mode	Super-high-speed mode		
Reflective models	Flat view	Standard	E32-L16-N 2M *	0 to 15					0 to 12	
		Small	E32-L24S 2M *	0 to 4						
	Top view	---	E32-L25L 2M *	5.4 to 9 (center 7.2)						
	Flat view		E32-L24L 2M *	2 to 6 (center 4)						

* If operation is affected by the background, perform power tuning to reduce the amount of light that is received.

Fiber Unit			Amplifier Unit	E3X-DA□R-S (□: 21/51/7/9)				
Detection of transparent objects (Retro-reflective)			Sensing distance (unit: mm)					
Sensing method	Type	Model	Tough mode	High-resolution mode	Standard mode	High-speed mode	Super-high-speed mode	
Retro-reflective models	Square	E32-R16 5M + E39-R1 (attached) *1	150 to 1,500					
	Small	E32-R21 2M + E39-R3 (attached) *1	10 to 250					
	Film detection *2	E32-C31 2M + E39-F3R+E39-RP37 *1	250	200	150	100	50	
		E32-C31 2M + E39-F3R+E39-RSP1 *1	600	300	225	150	75	

*1. When using a highly reflective object, light reflected from the object may affect the sensor.

*2. The effect may be small due to the film. Also, stable detection may not be possible when there is a sensing object directly in front of the Lens Unit. Be sure to check operation in advance.

Fiber Unit				Amplifier Unit	E3X-DA□R-S (□: 21/51/7/9)				
FPD / Semiconductor / Solar battery industry				Sensing distance (unit: mm)					
Sensing method	Application	Operating temperature	Model	Tough mode	High-resolution mode	Standard mode	High-speed mode	Super-high-speed mode	
Reflective models	Glass detection	70°C	E32-L16-N 2M *	0 to 15				0 to 12	
	Glass substrate alignment		E32-L16-N 2M *	0 to 15				0 to 12	
			E32-A08 2M *	10 to 20					
	Glass substrate mapping	300°C	E32-A08H2 3M *	10 to 20					
		70°C	E32-A09 2M	15 to 38					
		150°C	E32-A09H 2M	15 to 38					
		300°C	E32-A09H2 2M	20 to 30					
	WET process	60°C	E32-L11FP 5M	8 to 20 mm from end of lens (recommended: 11 mm)					
		70°C	E32-L12FS 5M	8 to 20 mm from end of lens (recommended: 11 mm)					
		85°C	E32-L11FS 5M	8 to 20 mm from end of lens (recommended: 11 mm)					
Through-beam models	Wafer mapping	70°C	E32-A03 2M	1,610	1,150	890	600	250	
			E32-A03-1 2M	1,610	1,150	890	600	250	
			E32-A04 2M	640	460	340	225	100	
			E32-A04-1 2M	640	460	340	225	100	

* If operation is affected by the background, perform power tuning to reduce the amount of light that is received.

Fiber Unit				Amplifier Unit	E3X-DA□R-S (□: 21/51/7/9)				
Liquid-level detection model				Sensing distance (unit: mm)					
Sensing method	Sensing direction	Pipe diameter	Model	Tough mode	High-resolution mode	Standard mode	High-speed mode	Super-high-speed mode	
Reflective models	Mounted to pipe	No limit	E32-D36T 5M *	Applicable pipe: Transparent (no restriction on diameter)					
		φ8 to 10mm	E32-L25T 2M	Applicable pipe: Transparent pipe with diameter of 8 to 10 mm, recommended pipe wall thickness: 1 mm					
	Wet	---	E32-D82F1 4M *	Wet model					

* If a high level of light is received, perform power tuning to reduce the amount of light that is received.

For information on Fiber Units, refer to the Fiber Sensors Best Selection Catalog (Cat. No. E353).

I/O Circuit Diagrams

NPN Output

Model	Operation mode	Timing charts	Operation selector	Output circuit
E3X-DA21-S E3X-DA21R-S E3X-DA21F-S	Light-ON	ch1/ Incident light ch2 No incident light Operation indicator ON (orange) OFF Output transistor ON OFF Load Operate (e.g., relay) Reset (Between brown and black (orange) leads)	LIGHT ON (L-ON)	E3X-DA21-S
	Dark-ON	ch1/ Incident light ch2 No incident light Operation indicator ON (orange) OFF Output transistor ON OFF Load Operate (e.g., relay) Reset (Between brown and black (orange) leads)	DARK ON (D-ON)	
E3X-DA7-S E3X-DA7R-S E3X-DA7F-S	Light-ON	ch1/ Incident light ch2 No incident light Operation indicator ON (orange) OFF Output transistor ON OFF Load Operate (e.g., relay) Reset (Between brown and black (orange) leads)	LIGHT ON (L-ON)	E3X-DA7-S
	Dark-ON	ch1/ Incident light ch2 No incident light Operation indicator ON (orange) OFF Output transistor ON OFF Load Operate (e.g., relay) Reset (Between brown and black (orange) leads)	DARK ON (D-ON)	

PNP Output

Model	Operation mode	Timing charts	Operation selector	Output circuit
E3X-DA51-S E3X-DA51R-S E3X-DA51F-S	Light-ON	ch1/ Incident light ch2 No incident light Operation indicator ON (orange) OFF Output transistor ON OFF Load Operate (e.g., relay) Reset (Between blue and black (orange) leads)	LIGHT ON (L-ON)	E3X-DA51-S
	Dark-ON	ch1/ Incident light ch2 No incident light Operation indicator ON (orange) OFF Output transistor ON OFF Load Operate (e.g., relay) Reset (Between blue and black (orange) leads)	DARK ON (D-ON)	
E3X-DA9-S E3X-DA9R-S E3X-DA9F-S	Light-ON	ch1/ Incident light ch2 No incident light Operation indicator ON (orange) OFF Output transistor ON OFF Load Operate (e.g., relay) Reset (Between blue and black (orange) leads)	LIGHT ON (L-ON)	E3X-DA9-S
	Dark-ON	ch1/ Incident light ch2 No incident light Operation indicator ON (orange) OFF Output transistor ON OFF Load Operate (e.g., relay) Reset (Between blue and black (orange) leads)	DARK ON (D-ON)	

Note: 1. Operation with area settings is as follows:

LIGHT ON: ON when the incident level is between the thresholds for channels 1 and 2.

DARK ON: OFF when the incident level is between the thresholds for channels 1 and 2.

2. Timing Charts for Timer Settings (T: Set Time)

ON delay	OFF delay	One-shot	ON delay and OFF delay

T1: ON-delay set time
T2: OFF-delay set time
T1 and T2 can be set separately.

E3X-DA-S

Nomenclature

Amplifier Units

E3X-DA□-S (□: 21/51/7/9)

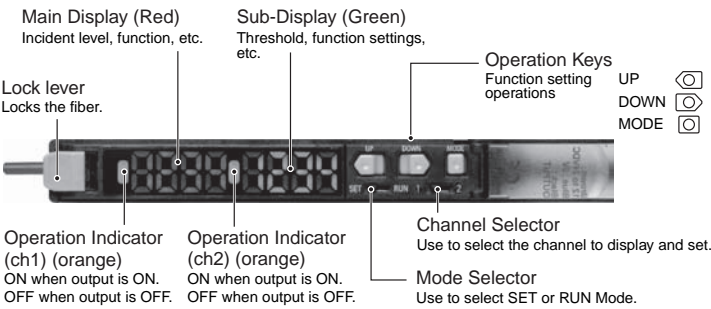

Note: Nomenclature and operating procedures for the E3X-DA□R-S and E3X-DA□F-S (□: 21/51/7/9) are given on pages 19 and 20.

Operating Procedure

1 Setting the Operation Mode

The operation mode is set in SET Mode.

→Refer to 5. Setting Functions on page 16.

Set the Channel Selector Switch to the desired channel before making any adjustments or settings.

2 Adjusting the Power (RUN Mode)

The current incident light level can be adjusted near the power tuning target value (default: 2,000).

* Confirm that the MODE Key setting is PTUN (power tuning). The default setting is PTUN.

→Refer to 5. Setting Functions on page 16.

* If power tuning is executed while SHS is selected for the detection function, the minimum power will be set.

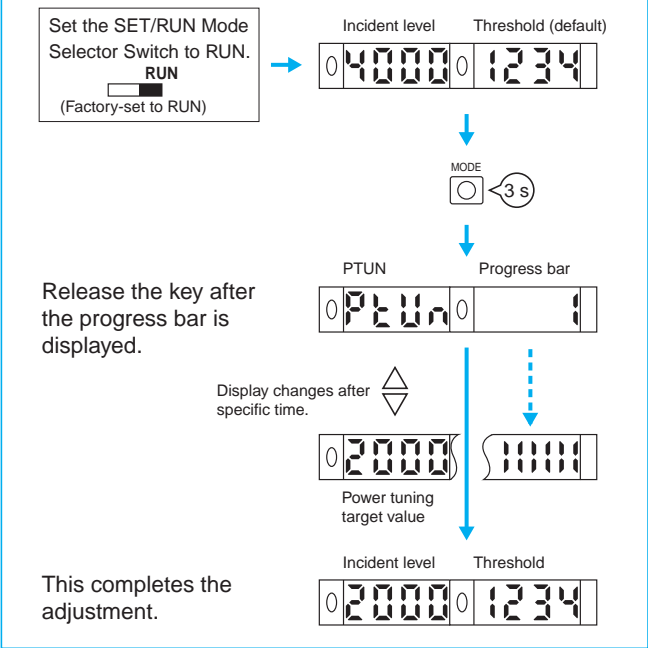

To restore the default power setting:

* Press the DOWN Key right after pressing the MODE Key.

"OFF" will flash twice.

PTUN OFF

Incident level: 0 4000 0, Threshold: 1234

This restores the default setting.

* Setting Errors

An error has occurred if one of the following displays appears after the progress bar is displayed.

Display	Error	Action
Flashes twice 0 Ptun 0 over	Over Error The incident light level is too low for the power tuning target value.	The power will not be tuned. The power can be increased up to approximately 5 times the incident light value.
Flashes twice 0 Ptun 0 botm	Bottom Error The incident light level is too high for the power tuning target value.	The power will be turned to the minimum level. The power can be decreased down to approximately 1/20th the incident light value.

3 Setting Thresholds Manually (RUN Mode)

A threshold can be set manually. A threshold can also be adjusted manually after teaching to fine-tune it.

Set the Mode Selector Switch to RUN. (Factory-set to RUN)

Light level: 0 2000 0, Threshold (default): 1234

UP / DOWN keys

Increases threshold. Decreases threshold.

* Even if the display method is changed, the threshold will appear on the sub-display when the key is pressed.

4 Teaching the Threshold (SET Mode)

- * There are five methods that can be used for teaching, as described below. Use the method most suitable for the application.
- * Two-point teaching, positioning teaching, and automatic teaching can be performed in RUN Mode.
- For operating procedures, refer to the *Instruction Manual* provided with the product.
- * An error has occurred if OVER or LO is displayed on the sub-display. If that occurs, repeat the operation from the beginning.

4-1. Setting the Threshold at Maximum Sensitivity

The threshold can be set to the maximum sensitivity. This is useful when the longest detection distance is required.

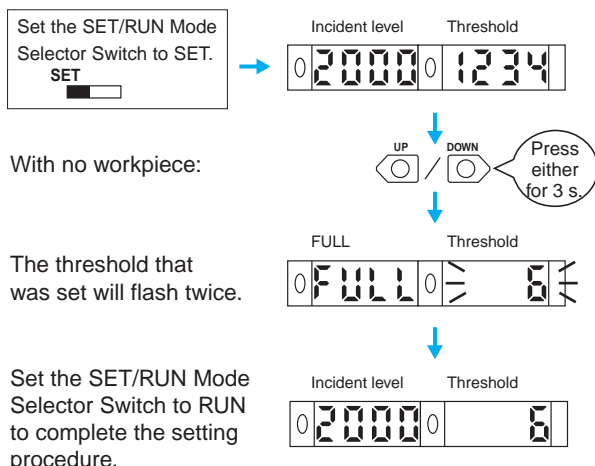

4-2. Teaching a Through-beam Fiber Unit without a Workpiece

You can set the threshold to below the incident light level without a workpiece by the percentage set for the teaching level.

→ Refer to 5. Setting Functions on page 16.

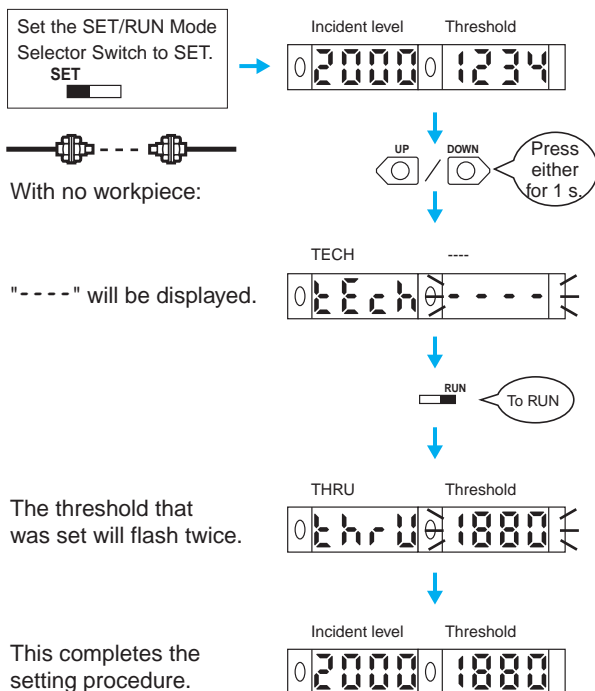

4-3. Teaching a Reflective Fiber Unit without a Workpiece

You can set the threshold to above the incident light level without a workpiece by the percentage set for the teaching level.

→ Refer to 5. Setting Functions on page 16.

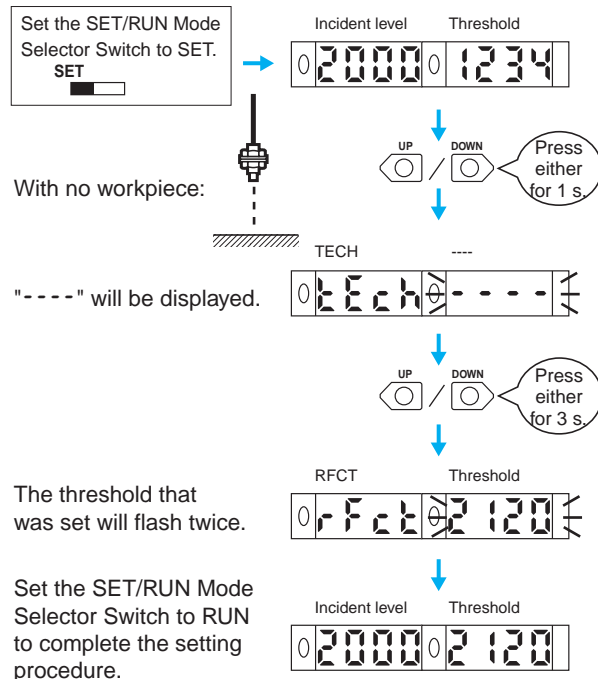

4-4. Two-point Teaching

4-5. Positioning Teaching

Two points in the following figures are detected, and the intermediate point of the light levels for the two points is set as the threshold.

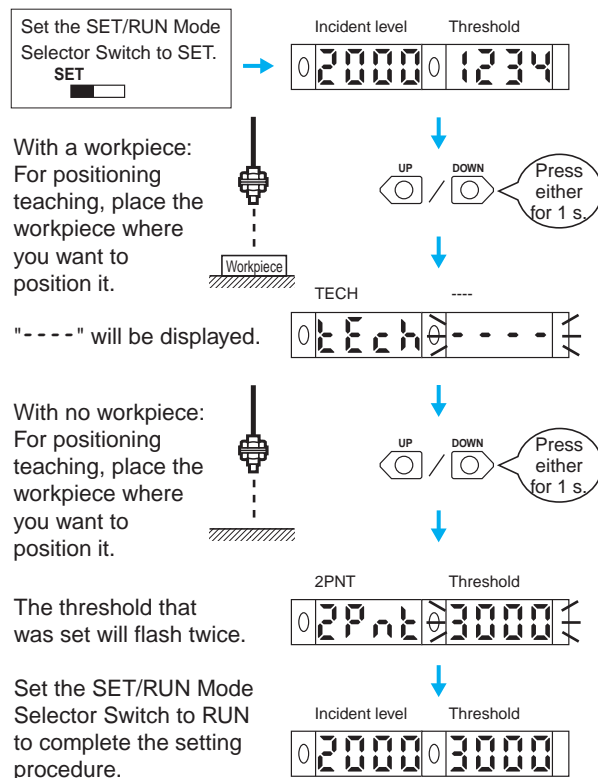

5 Setting Functions (SET Mode)

Moving between Functions →Refer to 4. Teaching the Threshold on page 15.

* The function transition boxes show the default settings.
* More functions may be displayed depending on the detailed settings.

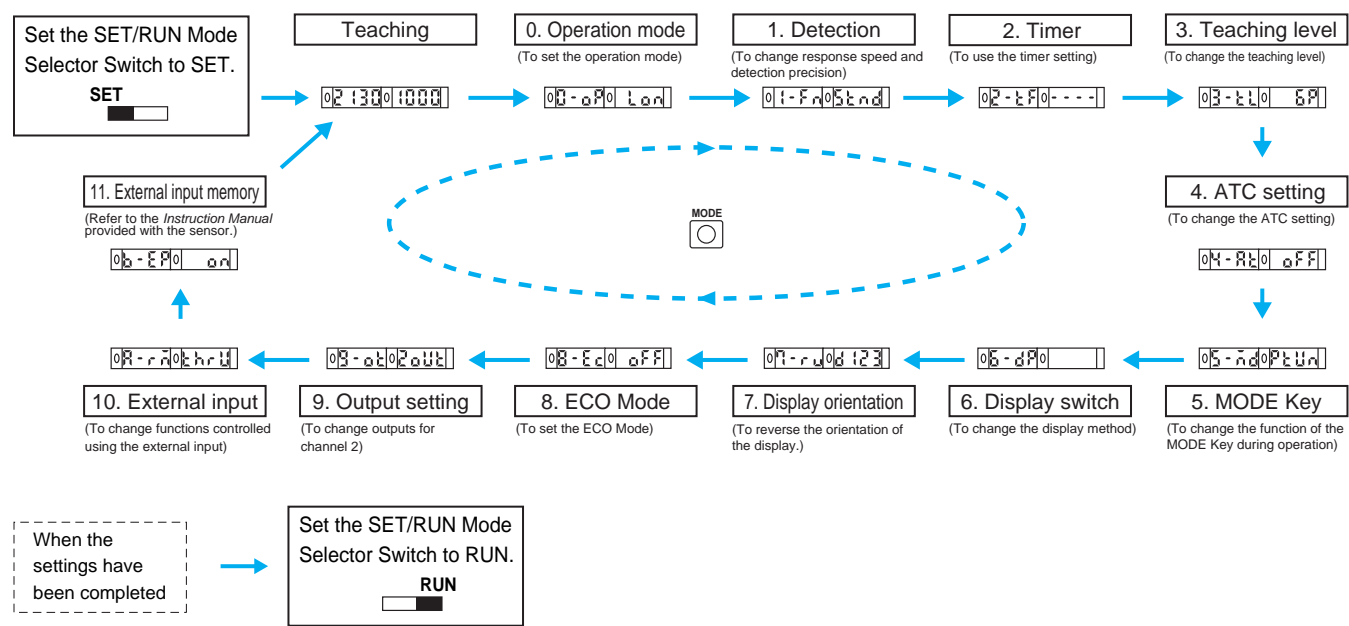

Functions

Use the UP and DOWN Keys to change the settings.

Function *	Setting (display)	Description
0. Operation mode	Light ON: L ON , Dark ON: d ON	→Refer to 1. Setting the Operation Mode on page 14.
1. Detection *	Super-high-speed: SHS , High-speed: HS , Standard: Std , High-resolution: HRS , Tough: Tg , Differential operation: dIF	Used to change the response speed or detection precision.
	Differential edge (differential operation selected) Single edge: SE , Double edge: DE	Used to set the edge to be detected.
	Differential time Single edge...250 μs : 1, 500 μs : 2, 1 ms: 3, 10 ms: 4, 100 ms: 5, Double edge...500 μs : 1, 1 ms: 2, 2 ms: 3, 20 ms: 4, 200 ms: 5	Used to set the differential response time.
2. Timer	Timer disabled: $\text{---$, OFF-delay timer: OFF , ON-delay timer: ON-d , One-shot timer: 1Shot , ON-delay + OFF-delay timer: ONdF	Used to enable or disable timers.
	Time (timer enabled) 1 to 20 ms: 1-ms increments, 20 to 200 ms: 10-ms increments, 200 ms to 1 s: 100-ms increments, 1 to 5 s: 1-s increments	Used to change timer settings when timers are enabled. The timer can be set from 1 to 5,000 ms.
3. Teaching level	Setting range: 0P to 99P	Used to change the threshold setting when teaching a Through-beam Fiber Unit without a workpiece or teaching a Reflective Fiber Unit without a workpiece.
4. ATC setting	ATC enabled: ON , ATC disabled: OFF	Used to enable or disable the ATC function.
	Setting at Power-ON (ATC ON) No setting: OFF , ATC start processing: Rtc , Power tuning and ATC start processing: PTrt	Used to set the processing to be performed when the power is turned ON.
5. MODE Key *	Executes power tuning: PTrt , Executes a zero reset: 0rSt , Two-point teaching: 2Pnt , Automatic teaching: AutT , ATC start: Rtc	Used to change the function of the MODE Key during RUN operation.
	Power tuning target value (performing power tuning) Setting range: 100 to 3,900 (increments of 100) Maximum power: Full	Used to set target values during power tuning. →Refer to 2. Adjusting the Power on page 14.

* The detection settings and MODE Key settings are the same for channel 1 and channel 2.
Other functions can be set separately for each channel.

Function	Setting (display)	Description
6. Display switch	 Incident level Threshold	Used to display the incident light level and the threshold.
	 % incident level Threshold	Used to display the incident light level as a percentage of the threshold and the threshold.
	 PEAK BOTM Fixed interval	Used to display the peak and bottom levels of incident light within a set time. (Updated every 2 s.)
	 L-PE D-BT	Use to display the incident light peak level and no incident light bottom level. (Refreshed when output turns ON or OFF.)
	 Detection status	Analog bar display. The current detection status is displayed as an analog bar. The bar will lengthen from the right as ON status is reached. (ON: Red, OFF: Green)
	 Current incident level PEAK Fixed interval Current incident level Peak incident level	Used to display the current incident light level and the peak incident light level. Display changes at a fixed interval.
	 Incident level Channel (unit number)	Used to display the incident light level and the channel (unit number).
7. Display orientation	Normal display: 3112, Up/down reversed display: 2113	Used to reverse the orientation of the display.
8. ECO Mode	Lit digital display: 0FF, Dimmed digital display: E00, OFF: E00	Used to enable or disable the ECO mode.
9. Output setting	Each channel: 2000, Output when the incident light level is between two thresholds: 0000, Self-diagnosis output: 5555	Used to change the output details for channel 2. This setting will be disabled if the detection function is set to DIFF (i.e., differential operation) and the output will be used for an alarm output.
10. External input	Through-beam, no-workpiece teaching: 0000, Reflective, no-workpiece teaching: 0000, Two-point teaching: 0000, Automatic teaching: 0000, Power tuning: 0000, Zero reset: 0000, Light OFF: 0000, ATC start: 0000	Used to change the functions to be controlled using the external input. (Refer to the <i>Instruction Manual</i> provided with the sensor.)
11. External input memory	Write results to EEPROM: 00, Do not write results to EEPROM: 0FF	Used to set writing the results. (Refer to <i>Instruction Manual</i> provided with the product.)

6 Convenient Functions

6-1. Setting the Digital Display to Zero (Zero Reset)

The incident light level on the main display can be set to 0. The incident light level and the threshold will both be shifted. This is useful when you want to set the reference display to zero.

* Change the function to 0RST (zero reset) with the MODE Key. The default setting is PTUN.
→ Refer to 5. Setting Functions on page 16.

Set the SET/RUN Mode Selector Switch to RUN.
Factory setting



To return to original value for incident light level:

Set the SET/RUN Mode Selector Switch to RUN.
Factory setting



6-2. Locking the Keys (Key Lock)

All key operations can be disabled.

Set the SET/RUN Mode Selector Switch to RUN.
Factory setting



"LOC ON" will flash twice and key operations will be disabled.



To release the lock:

Set the SET/RUN Mode Selector Switch to RUN.
Factory setting



"LOC OFF" will flash twice and key operations will be enabled.

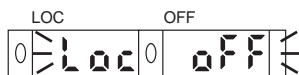

* If a key is pressed while key operations are locked, "LOC ON" will flash twice on the display to indicate that key operations have been disabled.

6-3. Resetting Settings (Initial Reset or User Reset)

All settings can be returned to the factory defaults or to user-saved settings.

Set the SET/RUN Mode Selector Switch to SET.
SET

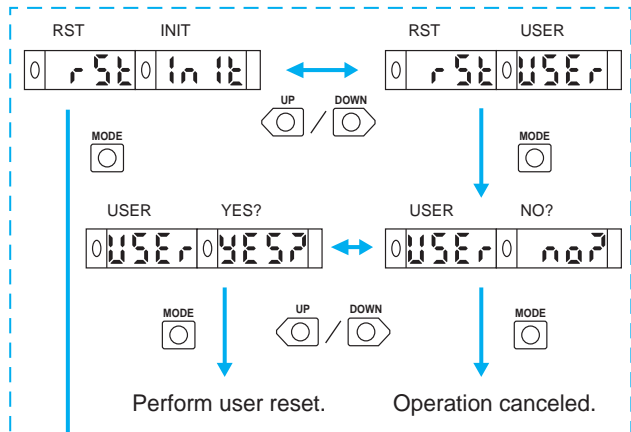
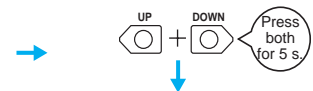

(The steps within the dotted lines can be used if settings have been saved by the user.)

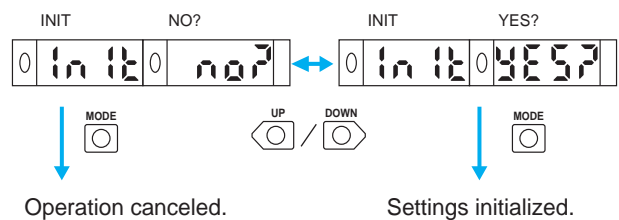

Saving User Settings

The current settings can be saved.

Set the SET/RUN Mode Selector Switch to SET.
SET

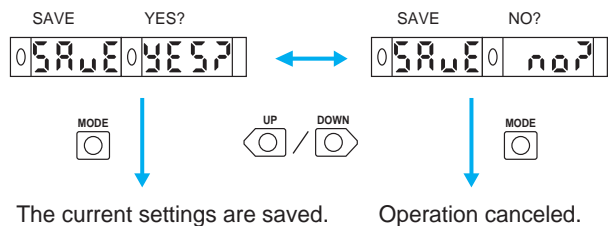
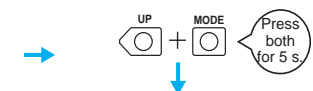

*1. Press the DOWN Key right after pressing the MODE Key.

*2. Press the UP Key right after pressing the MODE Key.

Nomenclature

Amplifier Units

E3X-DA□R-S (□: 21/51/7/9)

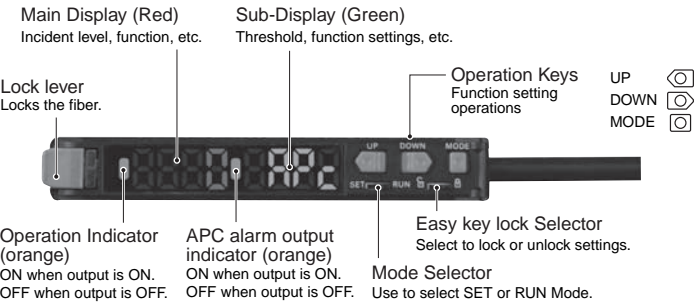

Operating Procedure

Basic operating procedures are as given on pages 14 to 18. For details, refer to the Instruction Manual provided with the product. This section shows functions specific to the E3X-DA□R-S.

1 Locking the Keys (Easy Key Lock)

Before shipment, all key operation except for the MODE Keys can be disabled.

Set the SET/RUN Mode Selector Switch to RUN.
RUN
(Factory-set to RUN)

Set the Easy Key Lock Selector Switch to Locked .
Locked

Note: Do not switch the lock while in SET Mode. Doing so will disable changing settings. If the lock is switched to in SET Mode, return to the unlock state, and then make the setting again.

Unlocking

Set the SET/RUN Mode Selector Switch to RUN.
RUN
(Factory-set to RUN)

Set the Easy Key Lock Selector Switch to Unlocked .
Unlocked

2 Displaying the APC Margin

Displaying the APC margin can be useful for planning maintenance. When the APC margin is 0%, APC alarm output will turn ON, and the APC alarm output indicator will light regardless of the operation of the APC margin display.

Set the SET/RUN Mode Selector Switch to RUN.
RUN
(Factory-set to RUN)

Set the Easy Key Lock Selector Switch to Locked .
Locked

Press the MODE Key to display the following for 10 s.

MODE

Initial status

Margin APC

0 100 0 APC

APC margin displayed in decrements of 10%

Margin APC

0 90 0 APC

APC margin of less than 10%

Margin APC

0 10 0 APC

The display switches every second.

ALAT APC

0 ALAT 0 APC

APC margin is 0%.

Margin APC

0 0 0 APC

The display switches every 0.5 s.

END APC

0 End 0 APC

Press the MODE Key or press nothing for 10 s.

MODE

The display will return to the normal display.

Incident level Threshold

0 1300 0 8

E3X-DA-S

Nomenclature

Amplifier Units

E3X-DA□F-S (□: 21/51/7/9)

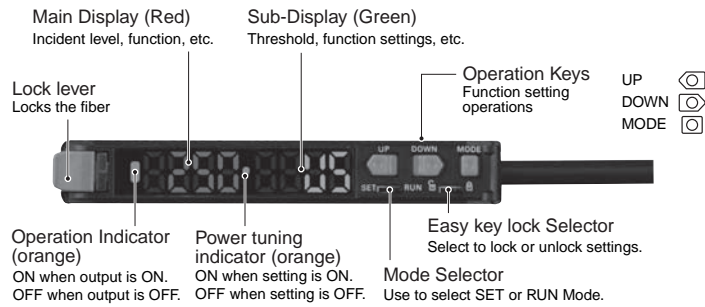

Operating Procedure

Basic operating procedures are as given on pages 14 to 18. For details, refer to the Instruction Manual provided with the product. This section shows functions specific to the E3X-DA□F-S.

1 Locking the Keys (Easy Key Lock)

Before shipment, all key operation except for the MODE Keys can be disabled.

Set the SET/RUN Mode Selector Switch to RUN.
RUN
(Factory-set to RUN)

Set the Easy Key Lock Selector Switch to Locked.
Locked

Note: Do not switch the lock while in SET Mode. Doing so will disable changing settings. If the lock is switched to in SET Mode, return to the unlock state, and then make the setting again.

Unlocking

Set the SET/RUN Mode Selector Switch to RUN.
RUN
(Factory-set to RUN)

Set the Easy Key Lock Selector Switch to Unlocked.
Unlocked

2 Displaying the Change of the incident level

Changes of the incident level for high-speed workpiece detection can be displayed. This enables checking the margin level of light received and the workpiece ON time in slow motion.

Set the SET/RUN Mode Selector Switch to RUN.
RUN
(Factory-set to RUN)

Set the Easy Key Lock Selector Switch to Locked.
Locked

Turn OFF the output or convey the workpieces.

Press the MODE key.

Incident level

Threshold

0 3112 2000

MODE

"A" is displayed when the output is ON or until approximately 10 s has elapsed. (Key operations will not be accepted in the status.)

STAT

0 52A 0

The incident level in intervals of 17 μ s will be displayed for approximately 20 s every 160 ms (between 0.5 ms before ON to 1.5 ms after ON).

Incident level

Threshold

0 3112 2000

Incident level

Threshold

0 1000 2000

Incident level

Threshold

0 2000 2000

Press the MODE Key, or wait for the slow-motion display to end.

MODE

The output ON time will be displayed.

Output ON time

Unit: μ s

0 250 05

END will be displayed.

END

0 End 0

The display will return to the normal display.

Incident level

Threshold

0 3112 2000

Error Display

The following will be displayed if the ON time exceeds 1,500 μ s.

OVER

US

0 0wEr 05

The following will be displayed if the change in the light amount is low. *

NON

DETC

0 non 0detc

* This may also be displayed when detecting a workpiece with a small change in light amount or a slow workpiece of 1,500 μ s or longer.

Safety Precautions

To ensure safe operation, be sure to read and follow the *Instruction Manual* provided with the sensor.



WARNING

This product is not designed or rated for ensuring safety of persons either directly or indirectly. Do not use it for such purposes.



CAUTION

Do not use the sensor with voltage in excess of the rated voltage. Excess voltage may result in malfunction or fire.



Never use the sensor with an AC power supply. Otherwise, explosion may result.



Precautions for Safe Use

The following precautions must be observed to ensure safe operation of the sensor.

1. Do not use the sensor in an environment where explosive or flammable gas is present.
2. Do not use the sensor in a location subject to splattering with water, streams, oils, or chemicals.
3. Do not attempt to disassemble, repair, or modify the sensor.
4. Do not apply voltages or currents that exceed the rated range to the sensor.
5. Do not use the sensor in an ambient atmosphere or environment that exceeds the ratings.
6. Wire the power supply correctly, including the polarity.
7. Connect the load correctly.
8. Do not short-circuit the load at both ends.
9. Do not use the sensor if the case is damaged.
10. Dispose of the sensor as industrial waste.
11. Do not use the sensor in locations subject to direct sunlight.

Precautions for Correct Use

Do not use the product in atmospheres or environments that exceed product ratings.

Amplifier Unit

Designing

Operation after Turning Power ON

The sensor is ready to detect within 200 ms after the power supply is turned ON. If the sensor and load are connected to separate power supplies, be sure to turn ON the sensor first.

Time may be required for the incident level to stabilize after the power supply is turned ON.

Operation at Power OFF

A pulse may be output when the power supply is turned OFF. Turn OFF the power supply to the load or the load line before turning OFF the power supply to the sensor.

Mutual Interference Protection Function

Mutual interference prevention is enabled if Amplifier Units are connected together. It is also enabled in the same way if E3X-DA-S-series Units and E3C-LDA-series Units are used together.

Mounting

Connecting and Disconnecting Connectors

Mounting Connectors

1. Insert the Master or Slave connector into the Amplifier Unit until it clicks into place.

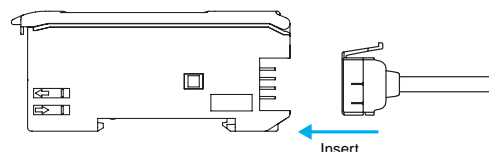

2. Attach the protective seals (provided as accessories) to the sides of master and slave connectors that are not connected.

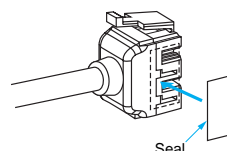

Note: Attach the seals to the sides with grooves.

Removing Connectors

1. Slide the slave Amplifier Unit away from the other unit.
2. After the Amplifier Unit has been separated, press down on the lever on the connector and remove it. (Do not attempt to remove a connector without first separating the Amplifier Unit from the other Units.)

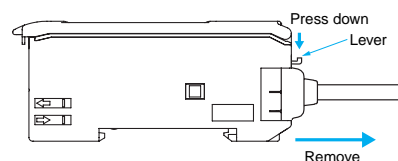

Adding and Removing Amplifier Units

Adding Amplifier Units

1. Mount the Amplifier Units one at a time onto the DIN track.

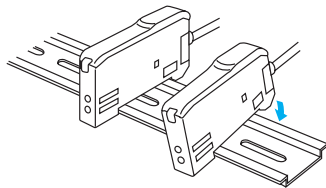

2. Slide the Amplifier Units together, line up the clips, and press the Amplifier Units together until they click into place.

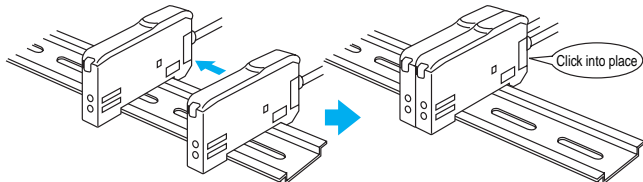

Removing Amplifier Units

Slide Amplifier Units away from each other, and remove from the DIN track one at a time. (Do not attempt to remove Amplifier Units from the DIN track without separating them first.)

- Note:**
1. The specifications for ambient temperature will vary according to the number of Amplifier Units used together. For details, →refer to *Ambient temperature range* on page 4.
 2. Always turn OFF the power supply before joining or separating Amplifier Units.

Mounting the End Plate (PFP-M)

Use an End Plate if the Amplifier Unit might move due to vibration.

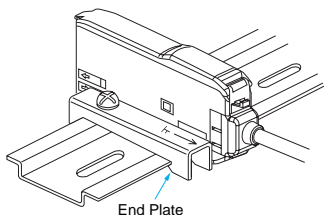

Fiber Connection

The E3X Amplifier Unit has a lock lever for easy connection of the Fiber Unit. Connect or disconnect the fibers using the following procedures:

1. Connecting Fibers

Open the protective cover, insert the fibers according to the fiber insertion marks on the side of the Amplifier Unit, and lower the lock lever.

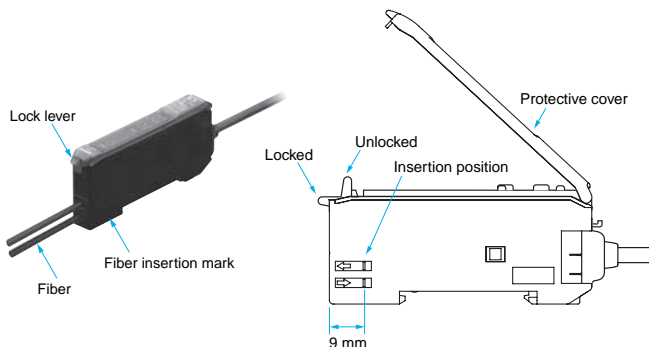

- Note:** Do not pull on the fiber, apply pressure on it, or otherwise subject it to excessive force when it is attached to the Amplifier Unit. (Use a force of 0.3 N·m max.)

Fibers with E39-F9 Attachment

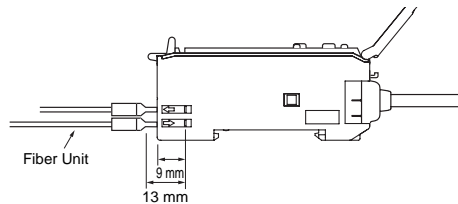

Fibers That Cannot Be Free-Cut (with Sleeves)

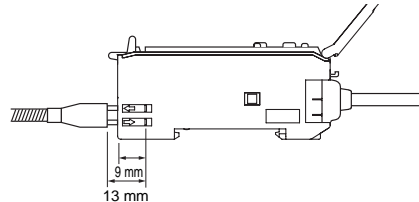

2. Disconnecting Fibers

Remove the protective cover and raise the lock lever to pull out the fibers.

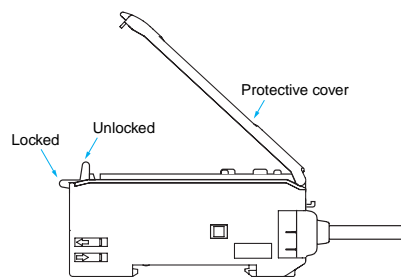

- Note:**
1. To maintain the fiber properties, confirm that the lock is released before removing the fibers.
 2. Be sure to lock or unlock the lock lever within an ambient temperature range between -10°C and 40°C .

Adjusting

Mutual Interference Protection Function

The values that appear on the digital display may fluctuate somewhat due to light from other sensors. If this occurs, you can stabilize detection by setting a threshold that is close to half way between the incident levels with and without a sensing object.

Output Short-circuits

OVER/CUR will flash on the display if the output short-circuit protection function operates due to a load short-circuit in a control output. If this occurs, check the load connections.

EEPROM Writing Error

If the data is not written to the EEPROM correctly due to a power failure or static-electric noise, initialize the settings with the keys on the Amplifier Unit. ERR/EEP will flash on the display when a writing error has occurred.

Optical Communications

Several Amplifier Units can be slid together and used in groups. Do not, however, slide the Amplifier Units or attempt to remove any of the Amplifier Units during operation.

Others

Protective Cover

Always keep the protective cover in place when using the Amplifier Unit.

Mobile Console

The E3X-MC11-SV2 Mobile Console does not currently support the new Tough Mode and ON-delay + OFF-delay timer. You also cannot use the E3X-MC-S.

Communications Unit

Use an E3X-DRT21-S Version 3 Communications Unit. This is not supported for the E3X-DA□R-S and E3X-DA□F-S (□: 21/51/7/9).

Dimensions

Tolerance class IT16 applies to dimensions in this data sheet unless otherwise specified.

Amplifier Units

Pre-wired Models

E3X-DA21-S
E3X-DA51-S
E3X-DA21R-S
E3X-DA51R-S
E3X-DA21F-S
E3X-DA51F-S

Digital Display Area

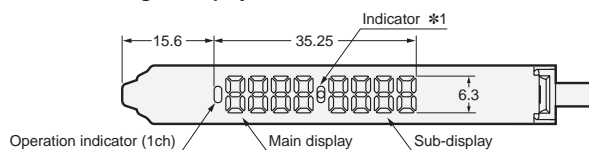

*1. The indicators are as follows:

E3X-DA21-S E3X-DA51-S	Operation indicator (2 ch)
E3X-DA21R-S E3X-DA51R-S	APC alarm output indicator
E3X-DA21F-S E3X-DA51F-S	Power tuning indicator

DIN track mounting

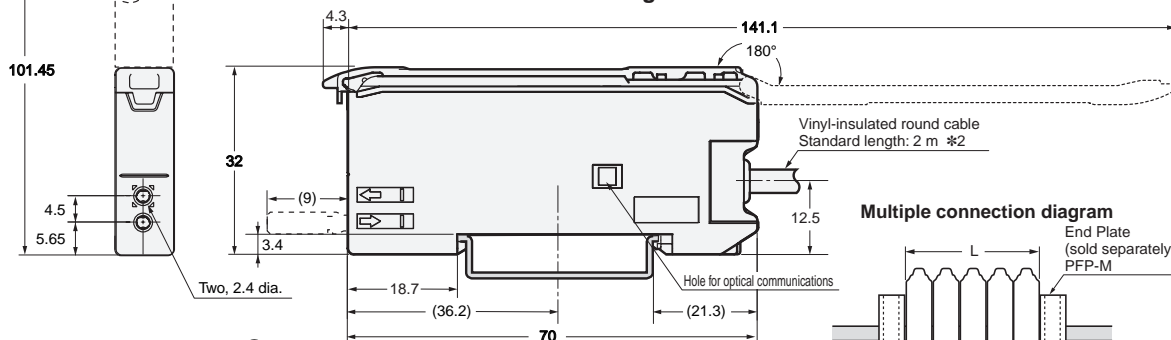

Multiple connection diagram

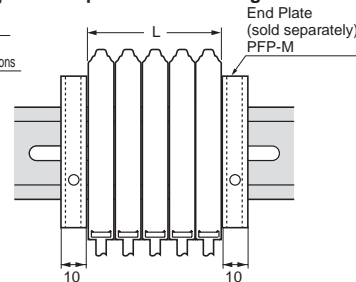

The number of expansion	L (mm)
1	10
2	20
3	30
4	40
5	50
6	60
7	70
8	80
9	90
10	100

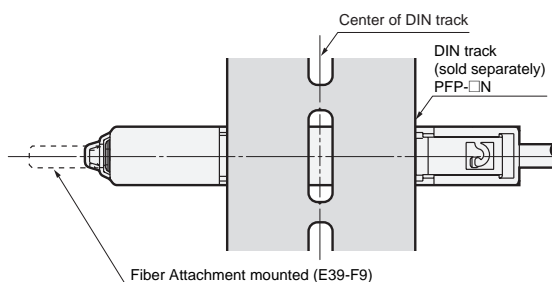

With Mounting Bracket Attached

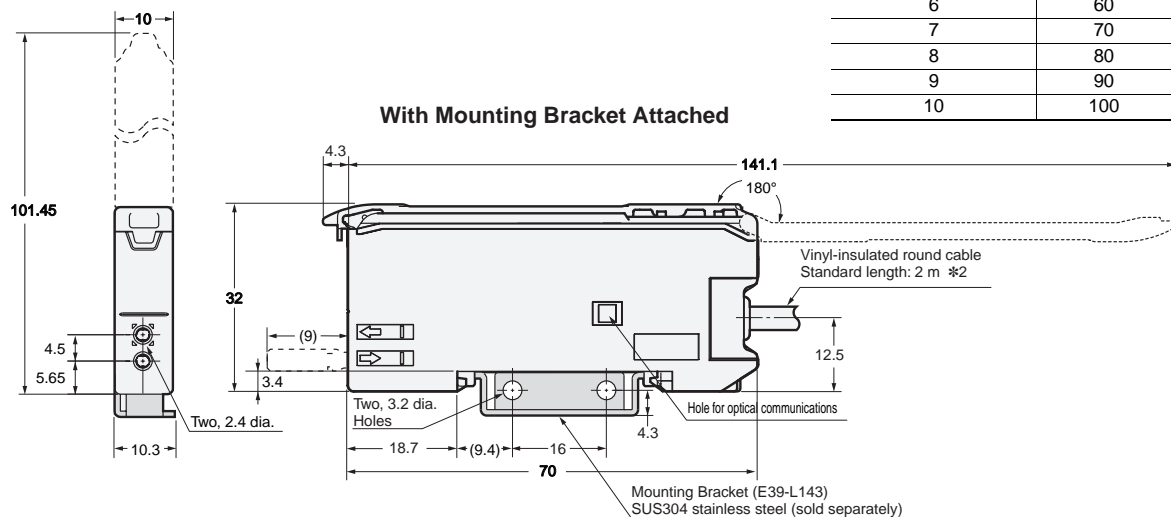

Mounting Holes

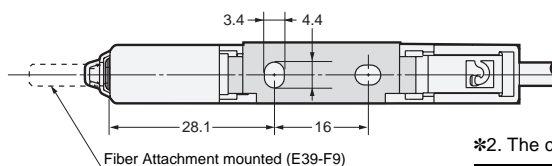
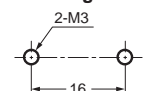

*2. The cable specifications are as follows:

E3X-DA21-S E3X-DA51-S E3X-DA21R-S E3X-DA51R-S	4 dia. cable / 5 conductors (Conductor cross section: 0.2 mm ² , Insulator diameter: 1.1 mm)
E3X-DA21F-S E3X-DA51F-S	4 dia. cable / 3 conductors (Conductor cross section: 0.2 mm ² , Insulator diameter: 1.1 mm)

Note: When using E39-L143 Mounting Brackets, there will be small gaps between the Amplifier Units if they are mounted side by side.

Wire-saving connector Models

E3X-DA7-S
E3X-DA9-S
E3X-DA7R-S
E3X-DA9R-S
E3X-DA7F-S
E3X-DA9F-S

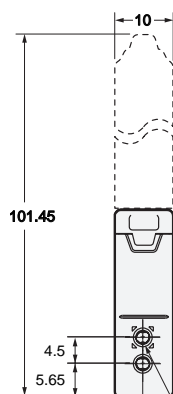

Digital Display Area

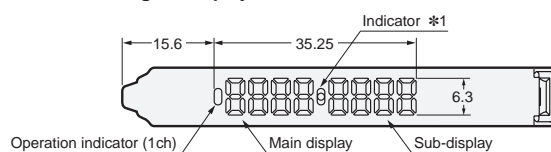

*1. The indicators are as follows:

E3X-DA7-S	Operation indicator (2 ch)
E3X-DA7R-S	APC alarm output indicator
E3X-DA9R-S	
E3X-DA7F-S	Power tuning indicator
E3X-DA9F-S	

DIN track mounting

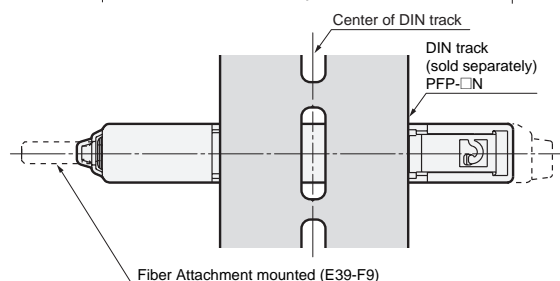
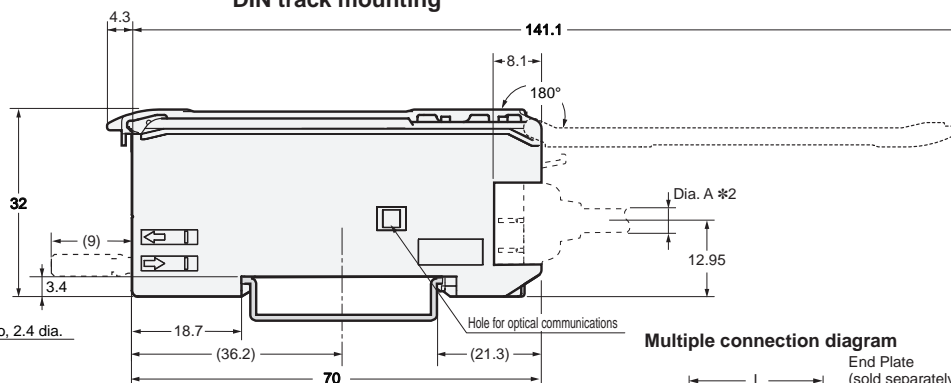

Multiple connection diagram

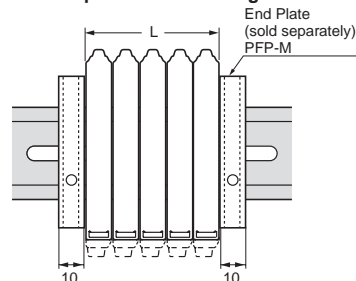

The number of expansion	L (mm)
1	10
2	20
3	30
4	40
5	50
6	60
7	70
8	80
9	90
10	100

With Mounting Bracket Attached

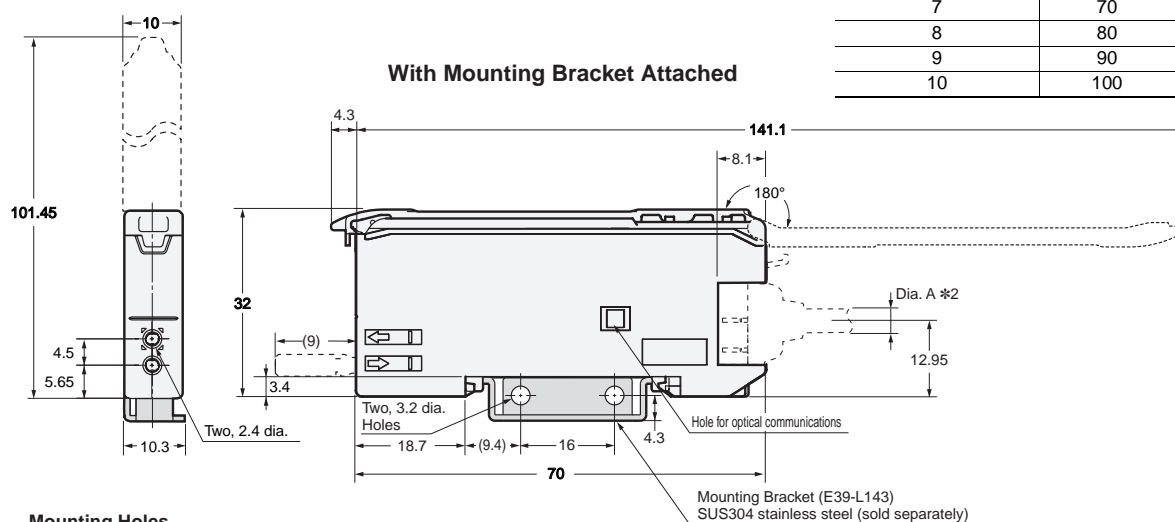

Mounting Holes

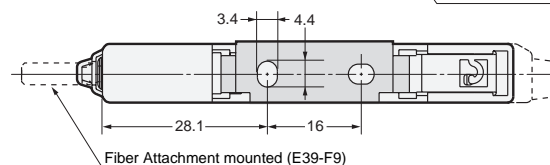
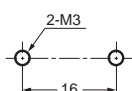

*2. The cable diameters are as follows:

E3X-CN21 (4 conductors)	4.0 dia.
E3X-CN22 (2 conductors)	
E3X-CN11 (3 conductors)	
E3X-CN12 (1 conductor)	2.6 dia.

Note: When using E39-L143 Mounting Brackets, there will be small gaps between the Amplifier Units if they are mounted side by side.

Wire-saving connector

Master connector E3X-CN21

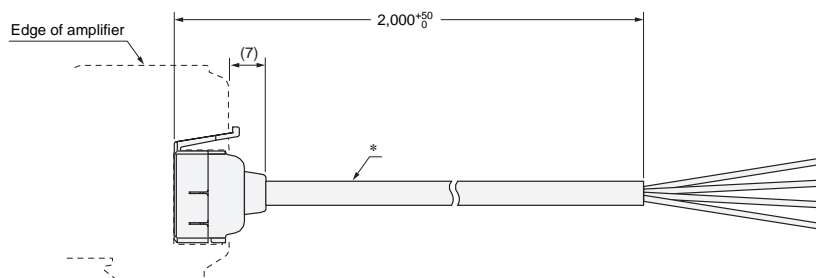

* E3X-CN21: 4-dia. vinyl-insulated round cable with 4 conductors (Conductor cross section: 0.2 mm², Insulator diameter: 1.1 mm)

Slave connector E3X-CN22

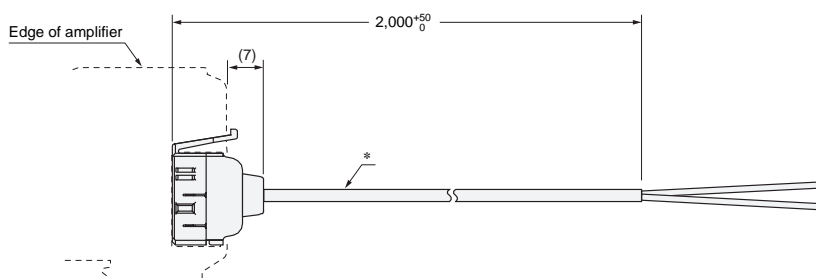

* E3X-CN22: 4-dia. vinyl-insulated round cable with 2 conductors (Conductor cross section: 0.2 mm², Insulator diameter: 1.1 mm)

Master connector E3X-CN11

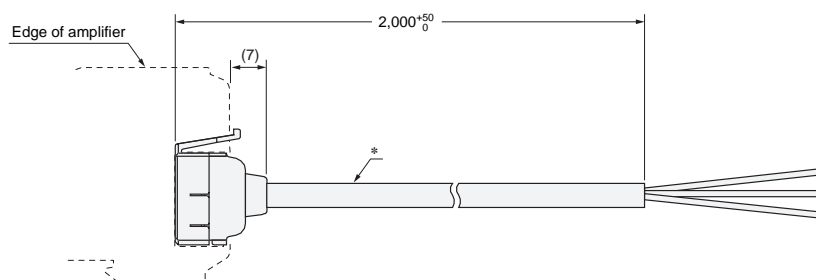

* Cable 4-dia. vinyl-insulated round cable with 3 conductors (Conductor cross section: 0.2 mm², Insulator diameter: 1.1 mm)

Slave connector E3X-CN12

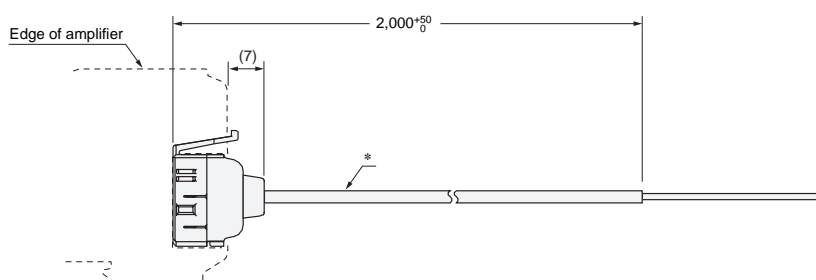

* Cable 2.6-dia. vinyl-insulated round cable with 1 conductors (Conductor cross section: 0.2 mm², Insulator diameter: 1.1 mm)

E3X-DA-S

Accessories (sold separately)

Mounting Brackets
E39-L143

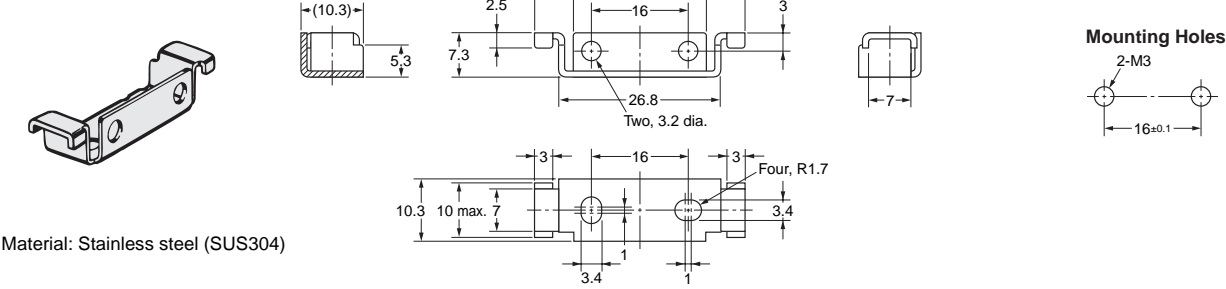

End Plate
PFP-M

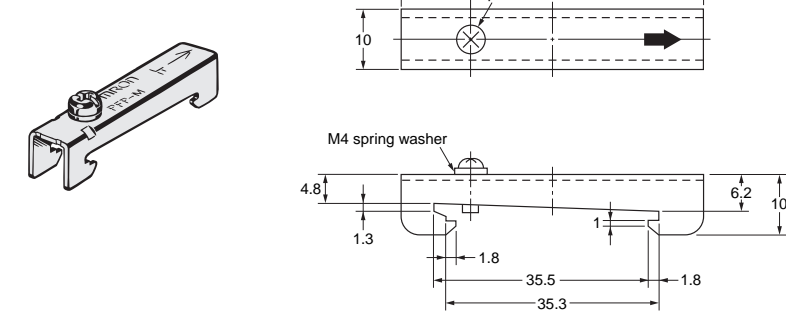

For information on Fiber Units, refer to the Fiber Sensors Best Selection Catalog (Cat. No. E353).

READ AND UNDERSTAND THIS DOCUMENT

Please read and understand this document before using the products. Please consult your OMRON representative if you have any questions or comments.

WARRANTY

OMRON's exclusive warranty is that the products are free from defects in materials and workmanship for a period of one year (or other period if specified) from date of sale by OMRON.

OMRON MAKES NO WARRANTY OR REPRESENTATION, EXPRESS OR IMPLIED, REGARDING NON-INFRINGEMENT, MERCHANTABILITY, OR FITNESS FOR PARTICULAR PURPOSE OF THE PRODUCTS. ANY BUYER OR USER ACKNOWLEDGES THAT THE BUYER OR USER ALONE HAS DETERMINED THAT THE PRODUCTS WILL SUITABLY MEET THE REQUIREMENTS OF THEIR INTENDED USE. OMRON DISCLAIMS ALL OTHER WARRANTIES, EXPRESS OR IMPLIED.

LIMITATIONS OF LIABILITY

OMRON SHALL NOT BE RESPONSIBLE FOR SPECIAL, INDIRECT, OR CONSEQUENTIAL DAMAGES, LOSS OF PROFITS OR COMMERCIAL LOSS IN ANY WAY CONNECTED WITH THE PRODUCTS, WHETHER SUCH CLAIM IS BASED ON CONTRACT, WARRANTY, NEGLIGENCE, OR STRICT LIABILITY.

In no event shall responsibility of OMRON for any act exceed the individual price of the product on which liability is asserted.

IN NO EVENT SHALL OMRON BE RESPONSIBLE FOR WARRANTY, REPAIR, OR OTHER CLAIMS REGARDING THE PRODUCTS UNLESS OMRON'S ANALYSIS CONFIRMS THAT THE PRODUCTS WERE PROPERLY HANDLED, STORED, INSTALLED, AND MAINTAINED AND NOT SUBJECT TO CONTAMINATION, ABUSE, MISUSE, OR INAPPROPRIATE MODIFICATION OR REPAIR.

SUITABILITY FOR USE

THE PRODUCTS CONTAINED IN THIS DOCUMENT ARE NOT SAFETY RATED. THEY ARE NOT DESIGNED OR RATED FOR ENSURING SAFETY OF PERSONS, AND SHOULD NOT BE RELIED UPON AS A SAFETY COMPONENT OR PROTECTIVE DEVICE FOR SUCH PURPOSES. Please refer to separate catalogs for OMRON's safety rated products.

OMRON shall not be responsible for conformity with any standards, codes, or regulations that apply to the combination of products in the customer's application or use of the product.

At the customer's request, OMRON will provide applicable third party certification documents identifying ratings and limitations of use that apply to the products. This information by itself is not sufficient for a complete determination of the suitability of the products in combination with the end product, machine, system, or other application or use.

The following are some examples of applications for which particular attention must be given. This is not intended to be an exhaustive list of all possible uses of the products, nor is it intended to imply that the uses listed may be suitable for the products:

- Outdoor use, uses involving potential chemical contamination or electrical interference, or conditions or uses not described in this document.
- Nuclear energy control systems, combustion systems, railroad systems, aviation systems, medical equipment, amusement machines, vehicles, safety equipment, and installations subject to separate industry or government regulations.
- Systems, machines, and equipment that could present a risk to life or property.

Please know and observe all prohibitions of use applicable to the products.

NEVER USE THE PRODUCTS FOR AN APPLICATION INVOLVING SERIOUS RISK TO LIFE OR PROPERTY WITHOUT ENSURING THAT THE SYSTEM AS A WHOLE HAS BEEN DESIGNED TO ADDRESS THE RISKS, AND THAT THE OMRON PRODUCT IS PROPERLY RATED AND INSTALLED FOR THE INTENDED USE WITHIN THE OVERALL EQUIPMENT OR SYSTEM.

PERFORMANCE DATA

Performance data given in this document is provided as a guide for the user in determining suitability and does not constitute a warranty. It may represent the result of OMRON's test conditions, and the users must correlate it to actual application requirements. Actual performance is subject to the OMRON Warranty and Limitations of Liability.

CHANGE IN SPECIFICATIONS

Product specifications and accessories may be changed at any time based on improvements and other reasons.

It is our practice to change model numbers when published ratings or features are changed, or when significant construction changes are made. However, some specifications of the product may be changed without any notice. When in doubt, special model numbers may be assigned to fix or establish key specifications for your application on your request. Please consult with your OMRON representative at any time to confirm actual specifications of purchased products.

DIMENSIONS AND WEIGHTS

Dimensions and weights are nominal and are not to be used for manufacturing purposes, even when tolerances are shown.

ERRORS AND OMISSIONS

The information in this document has been carefully checked and is believed to be accurate; however, no responsibility is assumed for clerical, typographical, or proofreading errors, or omissions.

PROGRAMMABLE PRODUCTS

OMRON shall not be responsible for the user's programming of a programmable product, or any consequence thereof.

COPYRIGHT AND COPY PERMISSION

This document shall not be copied for sales or promotions without permission.

This document is protected by copyright and is intended solely for use in conjunction with the product. Please notify us before copying or reproducing this document in any manner, for any other purpose. If copying or transmitting this document to another, please copy or transmit it in its entirety.

OMRON Corporation **Industrial Automation Company**
Tokyo, JAPAN

Contact: www.ia.omron.com

Regional Headquarters

OMRON EUROPE B.V.

Sensor Business Unit

Carl-Benz-Str. 4, D-71154 Nufringen, Germany
Tel: (49) 7032-8111-0/Fax: (49) 7032-811-199

OMRON ELECTRONICS LLC

One Commerce Drive Schaumburg,
IL 60173-5302 U.S.A.
Tel: (1) 847-843-7900/Fax: (1) 847-843-7787

OMRON ASIA PACIFIC PTE. LTD.

No. 438A Alexandra Road # 05-05/08 (Lobby 2),
Alexandra Technopark,
Singapore 119967
Tel: (65) 6835-3011/Fax: (65) 6835-2711

OMRON (CHINA) CO., LTD.

Room 2211, Bank of China Tower,
200 Yin Cheng Zhong Road,
PuDong New Area, Shanghai, 200120, China
Tel: (86) 21-5037-2222/Fax: (86) 21-5037-2200

Authorized Distributor:

© OMRON Corporation 2010 All Rights Reserved.
In the interest of product improvement,
specifications are subject to change without notice.

CSM_1_1_0510
Cat. No. E396-E1-02

Printed in Japan
(0510)