

PLEASE CHECK WWW.MOLEX.COM FOR LATEST PART INFORMATION

**Part Number:** [0011404575](#)  
**Status:** **Active**  
**Description:** Conductor Anvil

**Documents:**  
[RoHS Certificate of Compliance \(PDF\)](#)

General	
Product Family	Application Tooling
Series	T1719
Comments	See Tooling Specification (PDF) Above
Function	Cutter
Geographic Area	Global
Level of Automation	Semi-Automatic
More Detailed Tech Information	<a href="mailto:applicationtooling@molex.com">applicationtooling@molex.com</a>
Product Name	N/A
Survey	<a href="http://www.molex.com//review/apptool_survey.html">www.molex.com//review/apptool_survey.html</a>
Tool Type	Anvil

Material Info	
Old Part Number	8359 4

Reference - Drawing Numbers	
Application Tooling Documents	ATS-STANDARD-PARTS

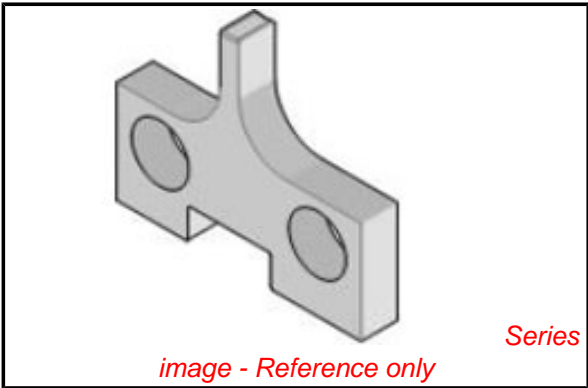

EU RoHS	China RoHS
<b>Compliance Status</b> <b>Not Reviewed</b>	
<b>REACH SVHC</b> <b>Not Reviewed</b>	
<b>Low-Halogen Status</b> <b>Not Reviewed</b>	

**Need more information on product environmental compliance?**

Email [productcompliance@molex.com](mailto:productcompliance@molex.com)  
For a multiple part number RoHS Certificate of Compliance, [click here](#)

Please visit the [Contact Us](#) section for any non-product compliance questions.

**Search Parts in this Series**  
[T1719Series](#)

**Use With**  
[0011402136](#) , [0011403132](#)

PLEASE CHECK WWW.MOLEX.COM FOR LATEST PART INFORMATION