

VICOR CONFIDENTIAL

THIS DOCUMENT AND THE DATA DISCLOSED  
HEREIN OR HEREWITH IS NOT TO BE REPRODUCED,  
USED, OR DISCLOSED IN WHOLE OR IN PART  
TO ANYONE WITHOUT PERMISSION OF VICOR CORP.

REV.	DESCRIPTION	DATE	APPROVED
#1	DRAWN FOR DEVELOPMENT	GCK 6/3/02	CF
#2	REVSD PER MRKUP	AK 7/11/02	MR

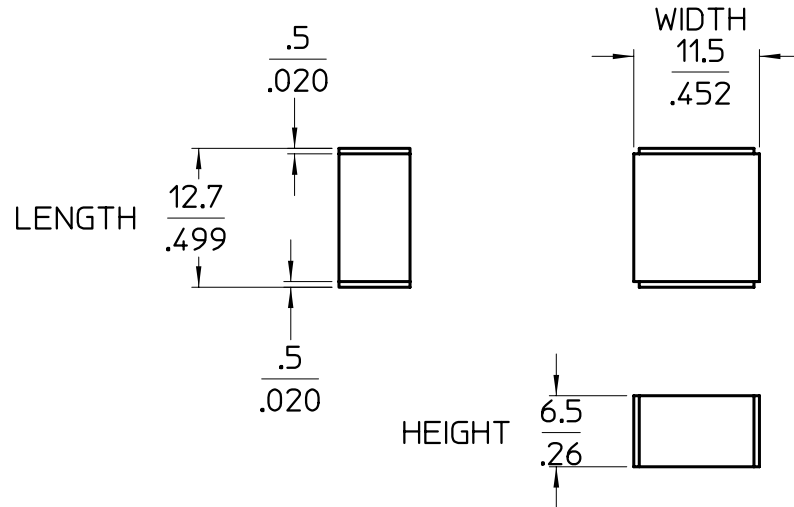

NOTES:

1. APPROVALS UL, CSA, S.
2. DIMENSIONS ARE IN MILLIMETERS/INCHES TOLERANCE  $\pm 0.2$  mm.
3. ELECTRODE TEMPERATURE, REFLOW SOLDERING.  
PREHEATING TEMPERATURE SHOULD BE LESS THAN 160°C. THE TIME ABOVE 180°C SHOULD BE LESS THAN 1 MINUTE. PEAK TEMPERATURE MUST NOT EXCEED 240°C.

*ELECTRICAL SPECIFICATIONS*

RATED VOLTAGE	250 VAC
CAPACITANCE	4700 pF
CAPACITANCE TOLERANCE	$\pm 20\%$
CLASS	Y CLASS
DISSIPATION FACTOR	1.3% @ 1kHz
DIELECTRIC VOLTAGE	3000 VDC
INSULATION RESISTANCE @ 500VDC	$\geq 12000M\Omega$
RECOMMENDED VOLTAGE IN DC APPLICATION	$\leq 1000$ VDC
TEMPERATURE RANGE	-40 TO +100°C

DRAWN BY <b>G.C. KEAY</b>	DATE <b>6/3/02</b>			
<small>UNLESS OTHERWISE SPECIFIED DIMENSIONS ARE IN INCHES- TOLERANCES ARE: FRACTIONS DECIMALS ANGLES *1/64 XX* .01 *1° XXX* .005</small>		<b>SMT CAPACITOR - (Y)</b> <b>4700 pF <math>\pm 20\%</math>, 250 VAC</b>		
THIRD ANGLE PROJECTION 	SIZE <b>B</b>	FSCM NO. <b>67131</b>	DWG NO. <b>25283</b>	REV <b>#2</b>
DO NOT SCALE DRAWING	SCALE 2:1	SHEET 1 OF 1		