

STANDARD BEARINGS

STD.TR.1

700-2440 60

700-2476

Thrust Races

Fax/post if you require any of the following:

- ☐ Radial Ball Bearings Product Sheet
- ☐ Pulleys Product Sheet
- ☐ Thrust Races Product Sheet
- ☐ Conveyor Bearings Product Sheet
- ☐ Wheels Product Sheet
- ☐ Wheels with Rubber Tyres Product Sheet
- ☐ Sliding Door Assemblies Product Sheet
- ☐ Corporate Brochure
- ☐ Visit from your local sales engineer

Name

Title

Company name

Address

Tel No

Fax No

BNL design and manufacture thermoplastic rolling element bearings offering design solutions to a wide variety of industries.

This is one in a series of seven standard product sheets available from BNL:

- Radial Ball Bearings
- Pulleys
- Thrust Races
- Conveyor Bearings
- Wheels
- Wheels with Rubber Tyres
- Sliding Door Assemblies

When selecting BNL bearings from these product sheets, please note that the acetal bearings may be used over a continuous temperature range of -50°C to +100°C and a maximum speed of 1500 rpm depending on size and loading. The BNL product, utilising either polypropylene or acetal, is compatible with a wide range of chemicals. However if you are unclear about the suitability for use in specific conditions, please contact us.

BNL offers a free design and prototype service to meet any requirements you may have outside of the standard product range. Please contact us for further information.

GENERAL INFORMATION TO TABLES OVERLEAF:

PREFIXES:	AC	CAGED
	AF	FULL COMPLEMENT
	AIB	INSERTED STEEL BEARING
	CM	CAGED, MACHINED
	ACS	STEEL INNER RACE
	DA	SKATE WHEEL-DOUBLE ROW
	SW	SKATE WHEEL-SINGLE ROW
	ACH	CAGED, HEXAGONAL BORE
	FT	THRUST WASHER

SUFFIXES:	DR	DOUBLE ROW
	MWO	WHEEL WITH 'O'RING
	P	PULLEY
	C	CONVEYOR
	W	WHEEL

MATERIALS

RACES: UNLESS INDICATED AS BEING POLYPROPYLENE (PP), ALL RACES ARE PRODUCED FROM ACETAL

BALLS: PRODUCTS CAN BE SUPPLIED WITH THE FOLLOWING BALLS:

- STAINLESS STEEL
- CARBON STEEL
- GLASS

SEE INDIVIDUAL PRODUCT GROUP FOR TYPE OF BALLS USED.

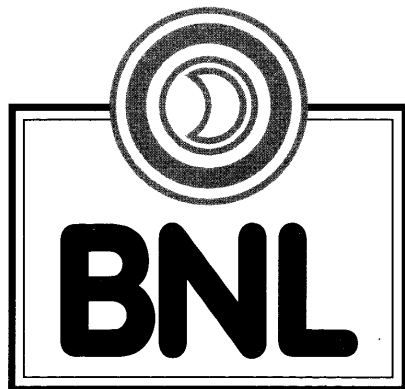

Sarnatech BNL Ltd, Manse Lane,
Knaresborough, N Yorkshire, HG5 8LF, England
Tel: +44 (0)1423 865621 Fax: +44 (0)1423 862259
Fax: +44 (1423) 862259

STANDARD BEARINGS

THRUST RACES

PART NO.	A	B	C	p.c.d	ball	no.	size inch(mm)
FT 4	1/4"	9/16"	1/16"	7/16"	8	3/32	(2.38)
FT 8 M	8.1	21.7	3	15.6	7	5/32	(3.96)
FT 10 M	10.2	21.7	3	15.6	7	5/32	(3.96)
FT 8.5	8.2	21.9	2.6	14.5	5	3/16	(4.76)
FT 7/8	7/8"	1 1/2"	1/8"	1 3/16"	14	3/16	(4.76)
51105 M	27.3	41	3	33.3	13	7/32	(5.55)
51108	41.2	59.6	4.6	50	18	9/32	(7.14)
FT 320 MOD	320	360	3.5	340	30	7/16	(11.1)

BALLS: CARBON STEEL

TYPICAL APPLICATIONS: SWIVEL CHAIRS, ROTATING EQUIPMENT

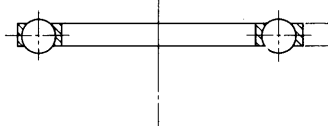
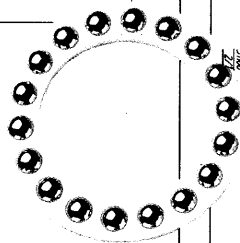
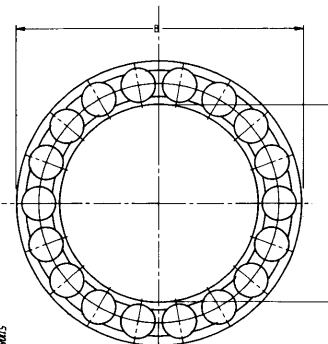

ROLLER

AF4 DR 2.1 CS

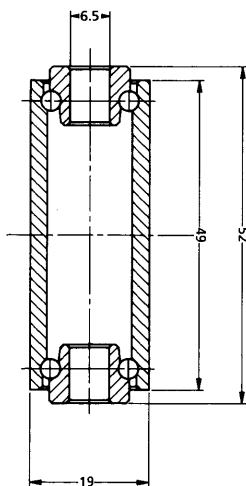

PILLOW BLOCK

LP20 SS 316

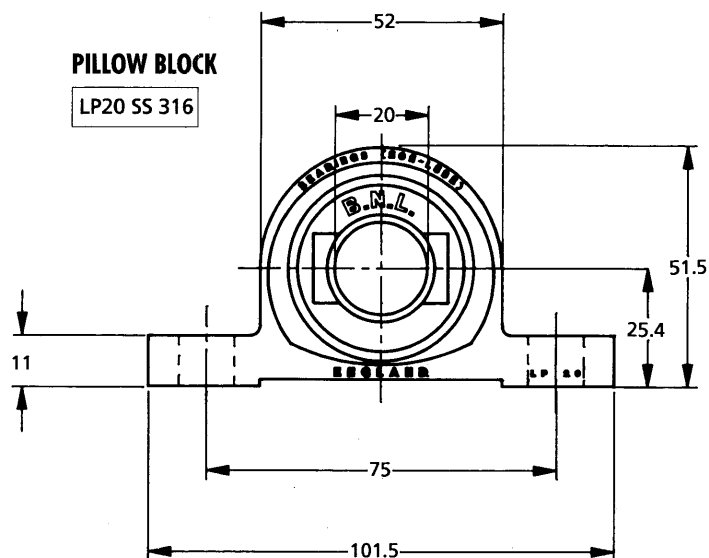

DIMENSIONS ARE FOR REFERENCE ONLY