

Extrusions

141-620

Printed Circuit Board Guides Series PCG PCG-A

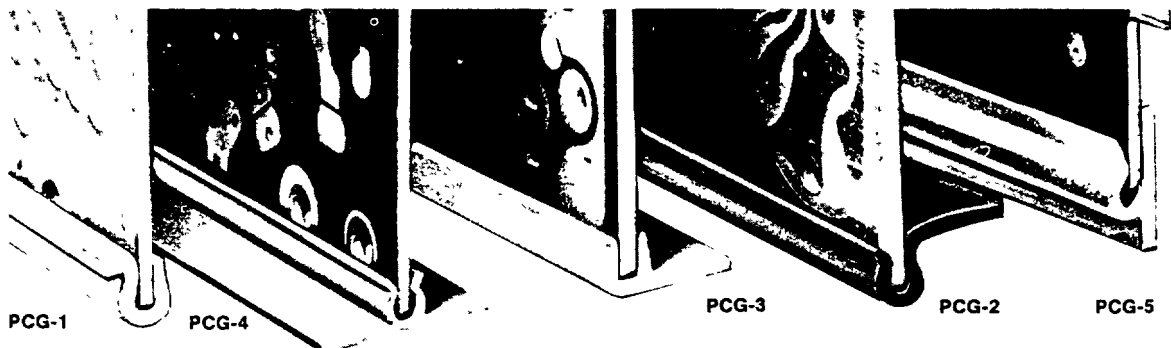

Plastic P.C. Board Guides Offer Low Initial Cost Plus Low Installation Cost

These P.C. Guides are made from accurately sized plastic extrusions and assure precision placement and alignment of circuit boards

They can be supplied cut to length to fit your specific application and drilled for screws or other mechanical fasteners

They are also available with adhesive bases so that no mechanical fastening is required—the guide is pressed into place in its proper position where it will stay without further fastening. Write for prices

Richco circuit board guides are designed to take circuit boards of 1.60mm thickness.

EXTRUSIONS SHOWN ABOVE CAN BE SUPPLIED WITH SELF ADHESIVE BACKING. TO ORDER EXTRUSION WITH SELF ADHESIVE ADD SUFFIX "A" EG PCG-4A.

SPECIFICATION FOR ADHESIVE SEE RMS-8

CROSS SECTION DIMENSIONS

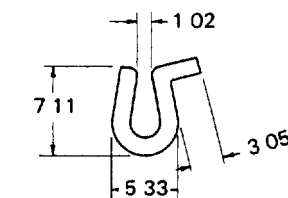

PCG-1
Material: Nylon 66 - See RMS-1

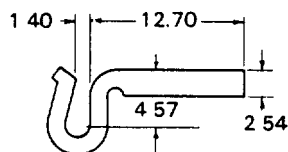

PCG-2
Material: A.B.S. - See RMS-10

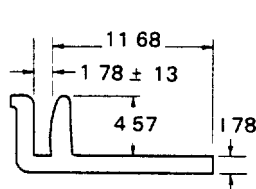

PCG-3
Material: A.B.S. See RMS-10

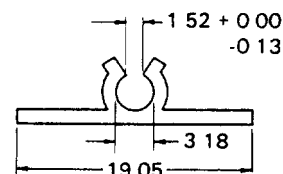

PCG-4
Material: H.D. PVC See RMS-4

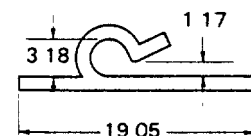

PCG-5
Material: H.D. PVC - See RMS-4

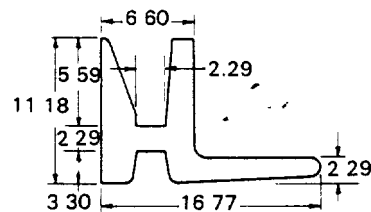

PCG-6
Material: A.B.S. See RMS-10

Board Mounting Strip Series BMS-S BMS-SA BMS-D BMS-DA

Mounts to Metal or Wood

- Single or dual channels
- With self-adhesive backing ... or tack or staple to wood
- Accommodates boards of any length or width
- Rigid, one-piece vinyl
- Cut to your length requirements

Simply snap your circuit board into the channels of two Series BMS hold down strips for quick, secure fastening

These rigid vinyl hold down strips are easy to apply, too, in any position. Just press the self-adhesive base to any material, or tack

or staple to wooden surfaces

Richco's Series BMS is available in two styles—for single boards or multiple side-by-side mounting. These hold down strips accommodate boards of any length or width because they are furnished cut to your length and can be spaced as required upon application

Part No. (without adhesive backing)	Nom. Base Width
BMS-S (Single Mount)	20 64
BMS-D (Double Mount)	31 75
Part No. (with adhesive backing)	Nom. Base Width
BMS-SA (Single Mount)	20 64
BMS-DA (Double Mount)	31 75