

## LTWC455 Series Ceramic Filter

LTWC455 series are surface mount ceramic filters widely used in telecommunication, cable, radar, TV set, tape recorder, video camera and other electronic products due to its lower price and stable performances.

# LTWC455

### Specifications:

#### Frequency Range (fc):

**LTWC455 Series:** 455KHz

**Tolerance:**  $\pm 1.5\text{KHz}$

**Operating Temperature:**  $-20^{\circ}\text{C} \sim +80^{\circ}\text{C}$  Standard

**Storage Temperature:**  $-40^{\circ}\text{C} \sim +85^{\circ}\text{C}$

<b>3dB and 6dB Bandwidth:</b>	B:	$\pm 10\text{KHz}$	$\pm 15.0\text{KHz}$
	C:	$\pm 8.0\text{KHz}$	$\pm 12.5\text{KHz}$
	D:	$\pm 7.0\text{KHz}$	$\pm 10.0\text{KHz}$
	E:	$\pm 5.5\text{KHz}$	$\pm 7.5\text{KHz}$
	F:	$\pm 4.0\text{KHz}$	$\pm 6.0\text{KHz}$
	G:	$\pm 3.0\text{KHz}$	$\pm 4.5\text{KHz}$
	H:	$\pm 1.5\text{KHz}$	$\pm 3.0\text{KHz}$

<b>50dB Bandwidth:</b>	B:	$\pm 30\text{KHz}$
	C:	$\pm 25\text{KHz}$
	D:	$\pm 20\text{KHz}$
	E:	$\pm 15\text{KHz}$
	F:	$\pm 12\text{KHz}$
	G:	$\pm 10\text{KHz}$
	H:	$\pm 9\text{KHz}$

**Stop Band Attenuation:** 50dB min (B,C,D,E)

at  $f_c \pm 100\text{KHz}$  47dB min (F,G)

**Insertion Loss:** 4.0dB max (B,C,D,E)  
6.0dB max (F,G,H)

**Ripple:** 2.0dB max

**Input/Output Impedance:**  $1.5\text{K}\Omega$

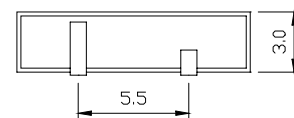
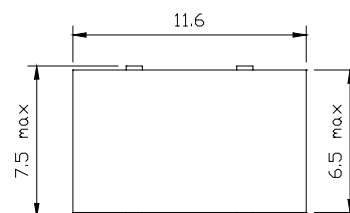

All dimensions are in mm

#### Note:

- Other frequencies, bandwidth ranges available. Consult VTC Support for specific requirements.
- Not all combinations of the above bandwidth ranges are available. Consult VTC Support if your requirement is not standard.
- All specifications subject to change without notice.

### LTWC455 Series

### Ordering Information

Product name + Frequency + Bandwidth Code.

i.e. LTWC455E