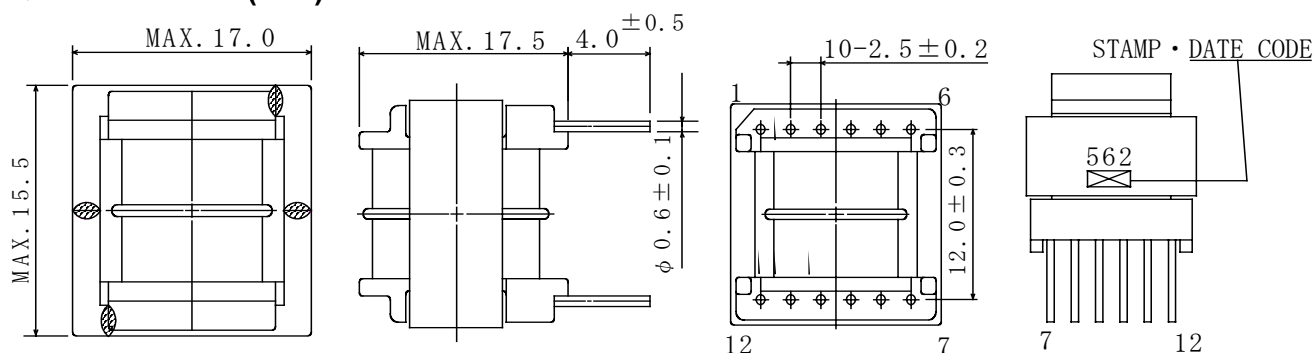
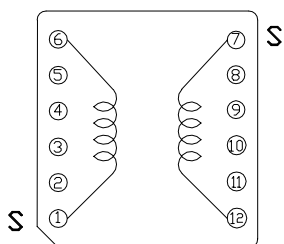

Type: EEH1617
◆ Product Description

- 17.0×15.5mm Max.(L×W),17.5mm Max. Height.
- EE core used for compatibility and competitive cost merit.

◆ Feature

- Correspondence with each ITU-T(Annex-A/E/C) standard.
- POTs splitter coils for ADSL splitter.
- RoHS Compliance.

◆ Dimensions (mm)

◆ Schematics(Bottom)

"S" is winding start.

◆ Specification(Part Number:SD16562)

		Measuring condition
Inductance	5.6mH±5% Within	1kHz
D.C.R.	6.5Ω MAX.	at 20℃
Isolation Voltage (1-6)&(7-12)	A.C. 1500Vrms 1Minute.	50Hz/60Hz