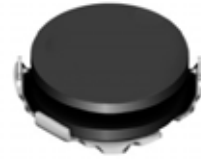
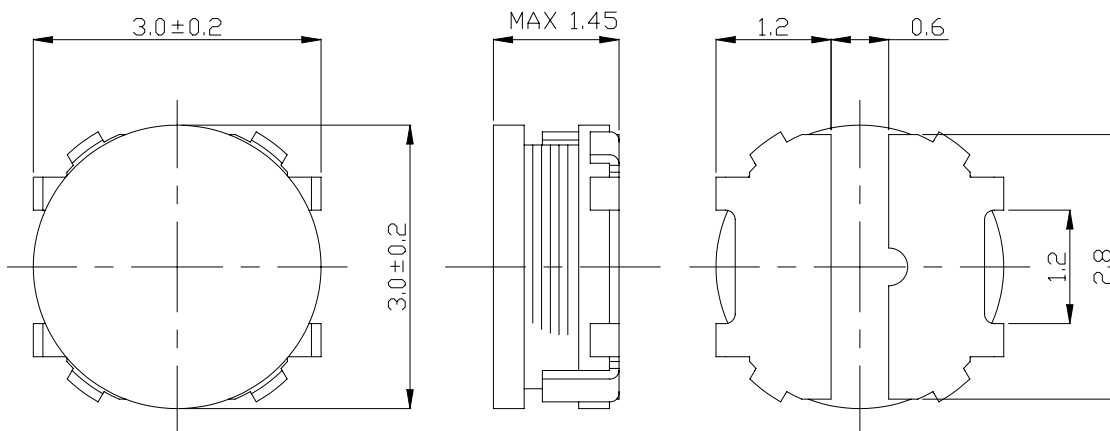
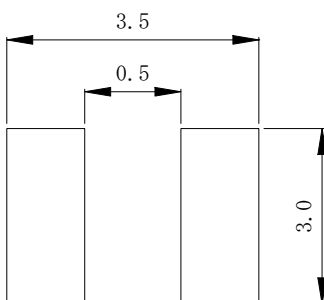

Type: CDH3D13D/SHP
◆ Product Description

- 3.2×3.2mm Max.(L×W),1.45mm Max. Height.
- Inductance Range: 1.2~22 μ H
- Rated Current Range: 0.55~1.90A
- In addition to the standard versions of inductors shown here, custom inductors are available to meet your exact requirements.

◆ Feature

- Magnetically unshielded construction.
- Ideally used in Mobile phone,PDA,MP3,DSC/DVC,Portable DVD etc as DC-DC Converter inductors.
- Dropping impact reinforced types.
- RoHS Compliance.

◆ Dimensions (mm)

◆ Land Pattern (mm)

Type: CDH3D13D/SHP
◆ Specification(CDH3D13D/SHP)

Part Name ※	Stamp	Inductance (μ H) 100kHz/1V	D.C.R.(m Ω) Max.(Typ.) (at 20°C)	Saturation Current (A) ※1		Temperature Rise Current (A) ※2
				(at 20°C)	(at 100°C)	
CDH3D13DSHPNP-1R2M□	A	1.2±20%	90.4(72.3)	2.30	1.70	1.90
CDH3D13DSHPNP-1R5M□	B	1.5±20%	102.5(82.0)	2.00	1.60	1.80
CDH3D13DSHPNP-2R2M□	C	2.2±20%	128.3(102.6)	1.70	1.30	1.60
CDH3D13DSHPNP-3R3M□	D	3.3±20%	156.6(125.3)	1.45	1.15	1.40
CDH3D13DSHPNP-4R7M□	E	4.7±20%	201.8(161.4)	1.20	1.00	1.20
CDH3D13DSHPNP-5R6M□	F	5.6±20%	259.5(207.6)	1.10	0.90	1.05
CDH3D13DSHPNP-6R8M□	G	6.8±20%	323.8(259.0)	1.00	0.75	1.00
CDH3D13DSHPNP-100M□	H	10.0±20%	415.0(332.0)	0.85	0.70	0.90
CDH3D13DSHPNP-120M□	I	12.0±20%	566.3(453.1)	0.72	0.60	0.70
CDH3D13DSHPNP-150M□	J	15.0±20%	725.3(580.2)	0.65	0.54	0.60
CDH3D13DSHPNP-220M□	K	22.0±20%	941.8(753.4)	0.55	0.40	0.55

※ Description of part name

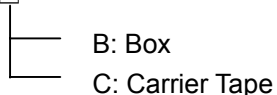
CDH3D13DSHPNP-1R2M□



※1.Saturation Current: The DC current at which the inductance decreases to 80% of its nominal value.

 ※2.Temperature Rise Current: The DC current at which the temperature rise is $\Delta t=40^{\circ}\text{C}$ ($T_a=20^{\circ}\text{C}$) .