

Type: CEP126

# UNDER DEVELOPMENT

## Product Description

- 13.0 × 13.0mm Max. (L × W), 6.2mm Max. height
- Inductance range: 3.0 μH
- Rated Current Range: 14.6A



## Feature

- Magnetically shielded construction.
- Super high current, Mn-Zn core used, Flat wire used.
- Ideally used in computer CPU power supply.
- RoHS Compliance

## Dimensions (mm)

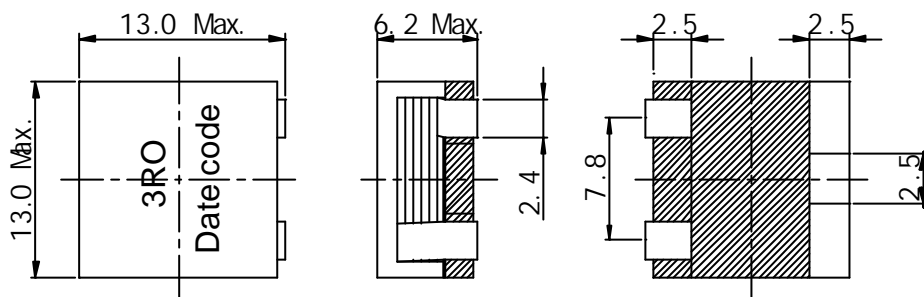

## Land Pattern (mm)

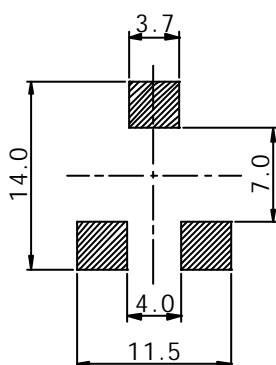

## Schematics (Bottom)

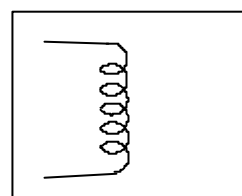

## Specification

Part Name	Stamp	Inductance [ Within ] 100kHz/1V	D.C.R(m Ω) Max. (at 20 °C)	Saturation current (A) 1	Temperature rise current (A) 2
CEP126NP-3R0MC	3R0	3.00 ± 20%	3.6	14.6 (18.2Typ)	15.5 (18.0Typ)

1. Saturation Current: The DC current at which the inductance decreases to 80% of its initial value .  
(Ta = 20 °C)

2 Temperature rise current: The DC current at which the temperature rise is t = 40 °C .(Ta = 20 °C)

**NOTE: THIS SPEC IS NOT THE FINAL ISSUE. AND MAYBE SOME PARTS WILL BE CHANGED BEFORE PRODUCTION.**