

# DT Series Miniature Double Pole Rocker Switches

**NEW!**



## Features/Benefits

- Illuminated versions available
- Double pole switching in miniature package
- Snap-in mounting
- RoHS compliant

## Typical Applications

- Small appliances
- Computers and peripherals
- Medical instrumentation



Models Available

## Specifications

### CONTACT RATING:

UL/CSA: 8 AMPS @ 125 VAC, 4 AMPS @ 250 VAC

VDE: 10 AMPS @ 125 VAC, 6 AMPS @ 250 VAC.

QH version: 16 AMPS @ 125 VAC, 10 AMPS @ 250 VAC

ELECTRICAL LIFE: 10,000 make and break cycles at full load.

INSULATION RESISTANCE:  $10^8 \Omega$  min.

DIELECTRIC STRENGTH: 1,500 VRMS @ sea level.

OPERATING TEMPERATURE: -20°C to +85°C

## Materials

HOUSING AND ACTUATOR: 6/6 nylon (UL94V-2), black, matte finish.

ILLUMINATED ACTUATOR: Polycarbonate, matte finish.

CENTER CONTACTS: Silver plated, copper alloy.

END CONTACTS: Silver plated AgCdo.

ALL TERMINALS: Silver plated, copper alloy.

**NOTE:** For the latest information regarding RoHS compliance, please go to: [www.ittcannon.com/rohs](http://www.ittcannon.com/rohs).

**NOTE:** Specifications and materials listed above are for switches with standard options. For information on specific and custom switches, consult Customer Service Center.

## Build-A-Switch

To order, simply select desired option from each category and place in the appropriate box. Available options are shown and described on pages H-67 through H-70. For additional options not shown in catalog, consult Customer Service Center.

<div>Switch Function</div> <div><b>DT12</b> SPST On-None-Off</div> <div><b>DT22</b> DPST On-None-Off</div>		<div>Actuator</div> <div><b>J1</b> Rocker</div> <div><b>J2</b> Two-tone rocker</div> <div><b>J3</b> Illuminated rocker</div>		<div>Actuator Color</div> <div><b>2</b> Black</div> <div><b>1</b> White</div> <div><b>3</b> Red</div> <div><b>R</b> Red, illuminated</div> <div><b>A</b> Amber, illuminated</div> <div><b>G</b> Green, illuminated</div>		<div>Mounting Style/Color</div> <div><b>S2</b> Snap-in, black</div> <div><b>S1</b> Snap-in, white</div> <div><b>B2</b> Recessed snap-in bracket, black</div> <div><b>G2</b> Guard, black</div>		<div>Termination</div> <div><b>15</b> .187" quick connect</div> <div><b>02</b> PC Thru-hole</div> <div><b>A</b> Right angle, PC thru-hole</div>		<div>Actuator Marking</div> <div><b>(NONE)</b> No marking</div> <div><b>D</b> ON-OFF</div> <div><b>H</b> "O I" - international ON-OFF</div> <div><b>N</b> Large dot</div> <div><b>P</b> "O -" international ON-OFF</div>		<div>Contact Rating</div> <div><b>QA</b> Silver (UL/CSA)</div> <div><b>QF</b> Silver (VDE)*</div> <div><b>QH</b> Silver (High current)*</div>		<div>Lamp Rating</div> <div><b>(NONE)</b> No lamp</div> <div><b>7</b> 125 VAC neon</div> <div><b>8</b> 250 VAC neon</div>	
--	--	--	--	--	--	--	--	---	--	--	--	---	--	---	--

\* QF available with termination 15 only.

Rocker



Dimensions are shown: Inch (mm)  
Specifications and dimensions subject to change

# DT Series Miniature Double Pole Rocker Switches

## SWITCH FUNCTION



NO. POLES	MODEL NO.	SWITCH FUNCTION		CONNECTED TERMINALS		SCHEMATIC
DP	<b>DT12</b>	ON	ON	2-3	2-1	 For Illuminated Versions
	<b>DT22</b>	ON	OFF			 For Illuminated Versions

## ACTUATOR



**J1** ROCKER

**J3** ILLUMINATED ROCKER

**J2** TWO-TONE ROCKER

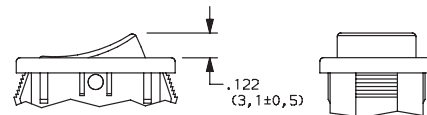
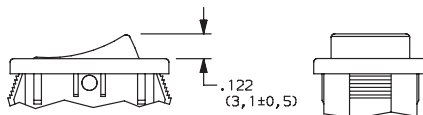

Dimensions are shown: Inch (mm)  
Specifications and dimensions subject to change



# DT Series Miniature Double Pole Rocker Switches

## ACTUATOR COLOR



OPTION CODE	ACTUATOR COLOR
<b>2</b>	BLACK
<b>1</b>	WHITE
<b>3</b>	RED
<b>R</b>	RED, ILLUMINATED
<b>A</b>	AMBER, ILLUMINATED
<b>G</b>	GREEN, ILLUMINATED

## MOUNTING STYLE/COLOR



**S2** SNAP-IN, BLACK

**S1** SNAP-IN, WHITE

**B2** RECESSED SNAP-IN BRACKET, BLACK

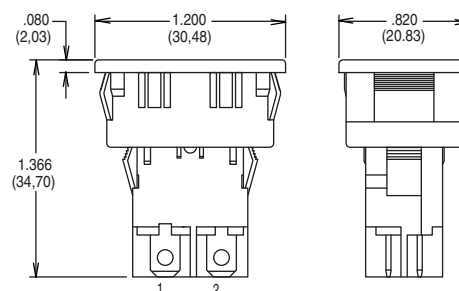
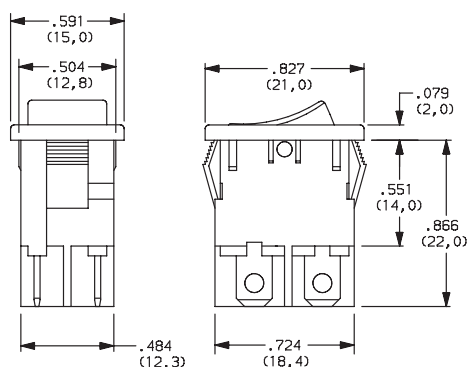

**NOTE:** Available with DT102 switch functions only.

**G2** GUARD, BLACK

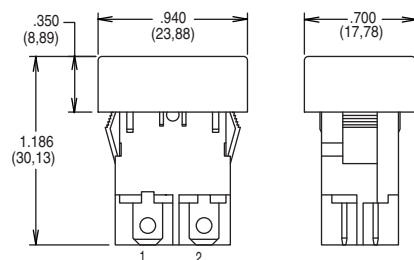

### PANEL MOUNTING

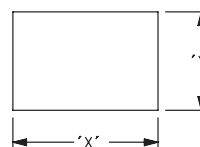

PANEL THICKNESS	"X"	"Y"
0.030-0.049 (0,75-1,25)	0.756-.004 (19,2-0,1)	0.512+.004 (13,0+0,1)
0.049-0.079 (1,25-2,0)	0.764-.004 (19,4-0,1)	0.512+.004 (13,0+0,1)
0.079-0.118 (2,0-3,0)	0.780-.004 (19,8-0,1)	0.512+.004 (13,0+0,1)

## TERMINATION



**15** .187" QUICK CONNECT

**02** PC THRU-HOLE

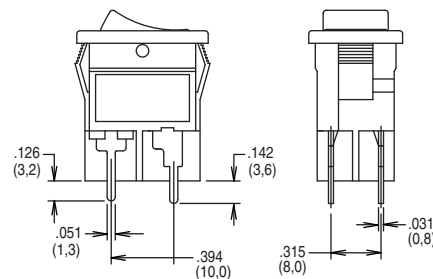
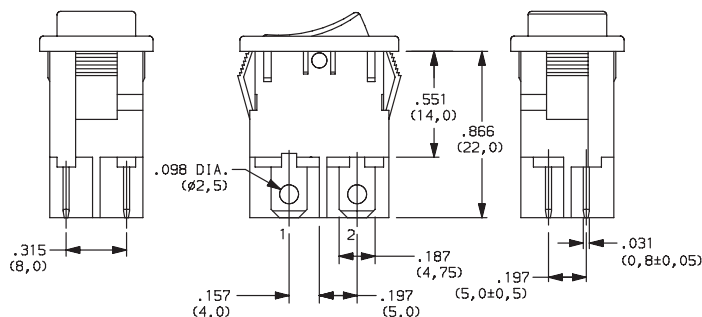

**NOTE:** No VDE approval of this option.

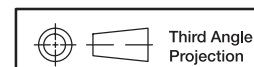

Dimensions are shown: Inch (mm)  
Specifications and dimensions subject to change

www.ittcannon.com



# DT Series Miniature Double Pole Rocker Switches

## TERMINATION

**A** RIGHT ANGLE, PC THRU-HOLE

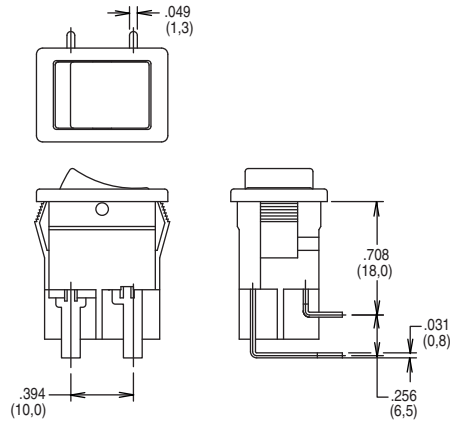

**NOTE:** No VDE approval of this option.

## ACTUATOR MARKING

**NONE** NO MARKING



**D** ON-OFF



**H** O-I



**N** LARGE DOT



**P** O -

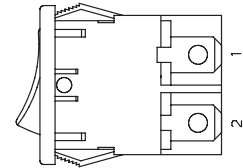

**NOTE:** Orientation of actuator marking and terminals.

## CONTACT MATERIAL

OPTION CODE	RoHS COMPLIANT *	RoHS COMPATIBLE *	CONTACT AND TERMINAL MATERIAL	RATINGS	
<b>QA</b>	YES	YES	SILVER	POWER	8 AMPS @ 125 VAC; 4 AMPS @ 250 VAC (UL/CSA)
<b>QF*</b>	YES	YES	SILVER	POWER	10 AMPS @ 125 VAC; 6 AMPS @ 250 VAC (VDE)
<b>QH*</b>	YES	YES	SILVER	POWER	16 AMPS @ 125 VAC; 10 AMPS @ 250 VAC

\*1 QF available with termination 15 only.

**NOTE:** For the latest information regarding RoHS compliance, please go to: [www.ittcannon.com/rohs](http://www.ittcannon.com/rohs).

## LAMP RATING

**(NONE)** NO LAMP

**7** 125 VAC 33kΩ NEON

**8** 250 VAC 150kΩ NEON

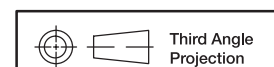

Dimensions are shown: Inch (mm)  
Specifications and dimensions subject to change