

DDR-2 DIMM SMT Vertical Mount Socket

FCN-07 Series

RoHS compliant

FEATURES

- DDR-2: 240pin DIMM socket connector
- Co-planarity of 0.1mm
- Fujitsu original unique structure for twin contact points structure, which is tolerant of dust and flux

Item	Specification
Operating temperature range	-55°C to +85°C
Current rating	AC 0.5A
Voltage rating	AC/DC 25V
Contact resistance	DC20mv, 10mA
Contact resistance	40mΩ maximum
Dielectric withstanding voltage	AC 0.25kV for 1 minute
Insulation resistance	250Mohm minimum

Item	Specification
Insulating material	LCP, UL94 V-0
Contact	Copper Alloy Plating NiPdAu
Heating resisting tape	PL

Plastic tray quantity: 16 pieces/tray
Container quantity: 16 x 5 = 80 pieces



Fujitsu's FCN-07 DDR-2 DIMM socket is a vertical mount SMT socket.

The unique contact structure provides for twin points of contact that insure that dust and flux are wiped clean when module is installed. In addition, the twin points guarantee constant contact between the module and contact even in a high vibration environment.



Fujitsu's precision stamping and molding allow the connector to have a coplanarity specification of 0.1mm. The connector has heat resistance tape added to the face of the connector for ease of vacuum pick-up.

Due to the overall length of the of the connector, Fujitsu has added a "solder bars" in the middle of the connector to insure proper IR processing when soldering the connector to the PCB.

■ SPECIFICATIONS

[illegible]

Scale: 1,000

FCN-07 series DDR-2DIMM Socket

SPECIFICATIONS

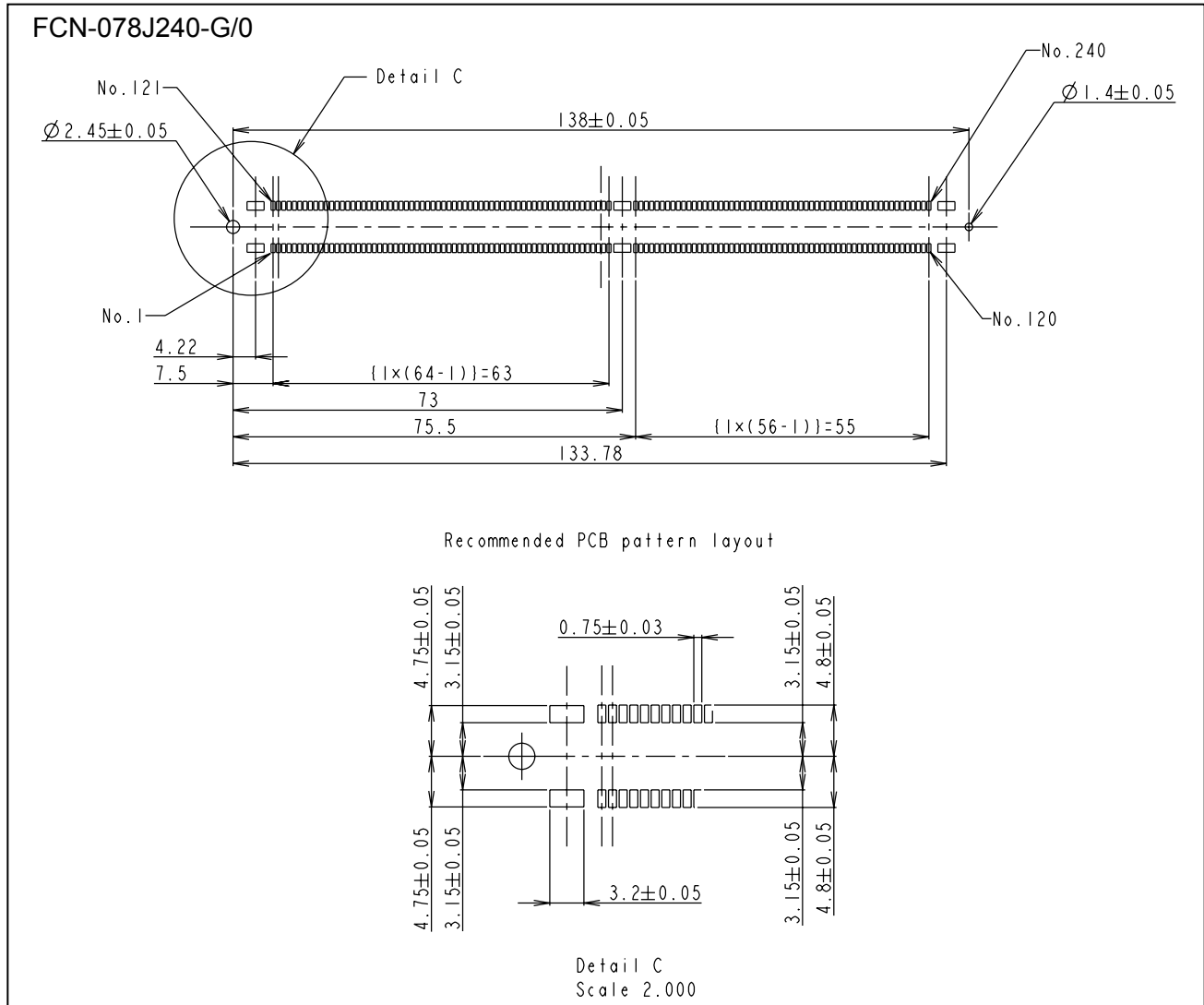

Fujitsu Components International Headquarter Offices

Japan

Fujitsu Component Limited
Gotanda-Chuo Building
3-5, Higashigotanda 2-chome, Shinagawa-ku
Tokyo 141 8630, Japan
Tel: (81-3) 5449-7010
Fax: (81-3) 5449-2626
Email: promothq@fcl.fujitsu.com
Web: www.fcl.fujitsu.com

North and South America

Fujitsu Components America, Inc.
250 E. Caribbean Drive
Sunnyvale, CA 94089 U.S.A.
Tel: (1-408) 745-4900
Fax: (1-408) 745-4970
Email: components@us.fujitsu.com
Web: <http://us.fujitsu.com/components/>

Europe

Fujitsu Components Europe B.V.
Diamantlaan 25
2132 WV Hoofddorp
Netherlands
Tel: (31-23) 5560910
Fax: (31-23) 5560950
Email: info@fceu.fujitsu.com
Web: emea.fujitsu.com/components/

Asia Pacific

Fujitsu Components Asia Ltd.
102E Pasir Panjang Road
#01-01 Citilink Warehouse Complex
Singapore 118529
Tel: (65) 6375-8560
Fax: (65) 6273-3021
Email: fcap@fcal.fujitsu.com
Web: <http://www.fujitsu.com/sg/services/micro/components/>

©2009 Fujitsu Components America, Inc. All rights reserved. All trademarks or registered trademarks are the property of their respective owners.

Fujitsu Components America or its affiliates do not warrant that the content of datasheet is error free. In a continuing effort to improve our products Fujitsu Components America, Inc. or its affiliates reserve the right to change specifications/datasheets without prior notice.
Rev. July 6, 2009.