

# G Series Crystal



- 5mm X 7mm X 4 Pads Ceramic Package
- Wide Frequency Range
- Tight Tolerance and Stability
- Tape and Reel Packaging



## ELECTRICAL SPECIFICATIONS:

Frequency Range	6.000MHZ to 100.000MHZ
Frequency Tolerance / Stability	(See Part Number Guide for Options)
Operating Temperature Range	(See Part Number Guide for Options)
Storage Temperature	-40°C to +85°C
Aging	±5ppm / first year Max
Shunt Capacitance	7pF Max
Load Capacitance	20pF Standard (See Part Number Guide for Options)
Equivalent Series Resistance	See ESR Chart
Mode of Operation	Fundamental, or 3 <sup>rd</sup> OT
Drive Level	1μW Typical
Insulation Resistance	500 Megaohms Min at 100VDC
Shock	MIL-STD-883, Meth 2002, Cond B
Solderability	MIL-STD-883, Meth 2003
Solvent Resistance	MIL-STD-202, Meth 215
Vibration	MIL-STD-883, Meth 2007, Cond A
Gross Leak Test	MIL-STD-883, Meth 1014, Cond C
Fine Leak Test	MIL-STD-883, Meth 1014, Cond A

## ESR CHART:

Frequency Range	ESR (Ohms)	Mode / Cut
6.000MHZ to 6.999MHZ	120 Max	Fund / AT
7.000MHZ to 7.999MHZ	110 Max	Fund / AT
8.000MHZ to 8.999MHZ	100 Max	Fund / AT
9.000MHZ to 9.999MHZ	90 Max	Fund / AT
10.000MHZ to 10.999MHZ	80 Max	Fund / AT
11.000MHZ to 11.999MHZ	70 Max	Fund / AT
12.000MHZ to 15.999MHZ	60 Max	Fund / AT
16.000MHZ to 39.999MHZ	40 Max	Fund / AT
40.000MHZ to 83.999MHZ	70 Max	3 <sup>rd</sup> OT / AT
84.000MHZ to 100.000MHZ	60 Max	3 <sup>rd</sup> OT / AT

## MARKING:

Line 1: MXX.XXX  
XX.XXX = Frequency in MHz

Line 2: SYMCCL  
S = Internal Code  
YM = Date Code (Year/Month)  
CC = Crystal Parameters Code  
L = Denotes RoHS Compliant

## MECHANICALS DETAIL:

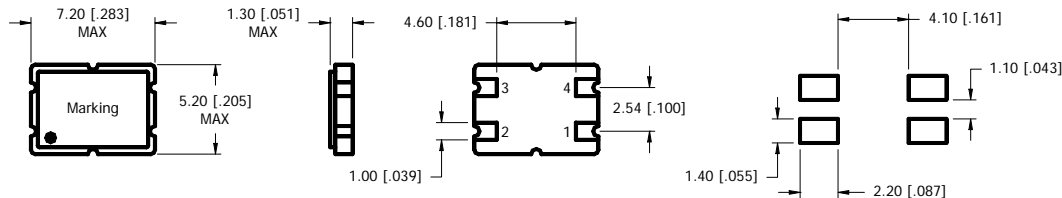

Dimension in Brackets are in Inches

Recommended Land Pattern

Pin Connections	
Pin 1	Crystal
Pin 2	Case Ground
Pin 3	Crystal
Pin 4	Case Ground

## PART NUMBER GUIDE:

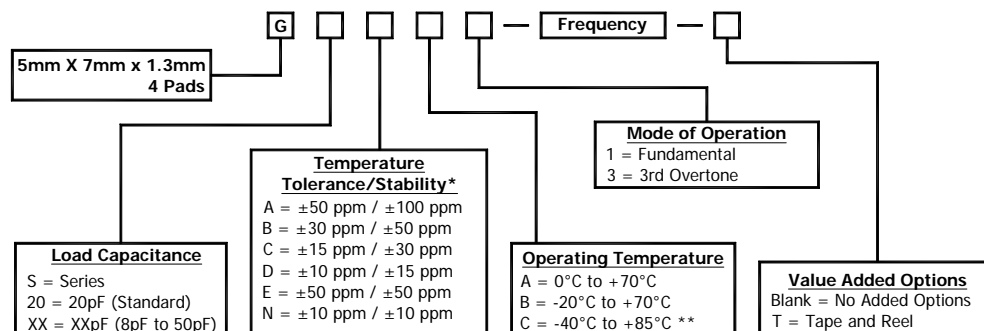

\* Please consult with MMD sales department for any other parameters or options.

\*\* Not all Frequency Tolerance/Stability options available at this temperature range.

**MMD Components, 30400 Esperanza, Rancho Santa Margarita, CA, 92688**

Phone: (949) 709-5075, Fax: (949) 709-3536, [www.mmdcomp.com](http://www.mmdcomp.com)

Sales@mmdcomp.com